

PRESTO®



the essentials | 2018

TAPWARE FOR INTENSIVE USE AND CHALLENGING ENVIRONMENTS

FRENCH TAPWARE SENSOR | SELF-CLOSING | SENSITIVE





TABLE OF CONTENTS



Washbasin

14



Shower

16



Centralised
mixing valve

20



Urinal valve

22



Flush valve

24



Mounting
frame

26



Sanifirst
washbasin

30

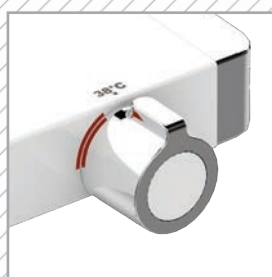

Sanifirst
shower

32



Professional
tapware

34



Mobility

36



PRESTO NEO® ONLY PRETTIER

Designed to **save energy** during intensive use, the PRESTO NEO range now includes a deck-mounted mixer tap, allowing the user to adjust the temperature.

Also available as a single tap, PRESTO NEO offers **great flexibility** in terms of installation thanks to its **three body lengths** for wall-mounted applications. Its new body, for deck-mounted applications, combines elegance, reliability and a sturdy construction.



PRESTO®
loves water

PRESTO NEO FOR WHICH AUDIENCE?

The PRESTO NEO is designed for intensive use, unsupervised facilities and locations at risk of vandalism:

- Junior high schools / High schools
- Gyms/Swimming pools
- Stations/Airports
- Service stations
- Outdoor accommodations



Stainless steel
deck-mounted version.

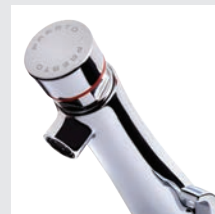

Chrome-plated deck-
mounted mixer version.



Wall-mounted versions with
3 lengths.

BENEFITS



CONTEMPORARY DESIGN: choice of chrome-plated brass or stainless steel finish.



FLEXIBILITY: easy to install thanks to 3 body lengths for wall-mounted applications and deck-mounted versions (single and mixer taps).



WATER SAVINGS: the unique PRESTO patent guarantees constant timed-flow. The PRESTOGREEN® (7 s or 1.9 l/min) and S® anti-blocking system help to control water consumption.



VANDAL-PROOF: its robust fastening system and antirotation button prevent any risk of premature wear.



PRESTO NEO® *Duo*

SIMPLE AND SMOOTH



The latest big technological innovation for saving energy, the PRESTO NEO *Duo*, includes “built-in” **dual timed-flow** thanks to a new action:

- **lifting the ergonomic lever** produces a short timed-flow of 7 seconds, which is enough to get your hands wet,
- **pressing down on the handle** results in a longer timed-flow of 11 seconds, which is ideal for rinsing your hands.





PRESTO®
loves water

PRESTO NEO Duo FOR WHICH AUDIENCE?

PRESTO NEO Duo is designed for users looking for maximum convenience:

- Early childhood facilities
- Nursery and primary schools
- Offices
- Outdoor accomodations



Deck-mounted version with green and light red levers.



Wall-mounted version with grey and light red levers.

BENEFITS



SOFT TOUCH: the ergonomic lever (which can be customised in light red or green) is suitable for children, the elderly and those with reduced mobility.



INTUITIVE: the icons are easy to identify.



WATER SAVINGS: the dual timed-flow ensures optimum management of water consumption because it is adapted to user habits (wet hands/rub with soap/rinse well).

SENSAO®

8400 N/8500/8600

USEFUL AND DISCREET

SENSAO 8400 N

The new exposed SENSÃO 8400 N sensor urinal offers a modern and modular design, suitable for many types of urinal with in-line or rear water inlets. Automatic, self-closing function, easy installation and maintenance makes SENSÃO 8400 N ideal for any public sanitary.



FOR WHICH AUDIENCE?

The SENSÃO 8400 N is designed for intensive use locations requiring effective, economical and robust facilities:

- Airports
- Offices
- Restaurants
- Shopping centres
- Theatres/Cinemas
- Stadium



B
E
N
E
F
I
T
S



WATER SAVINGS: self-closing flush, flow time can be adjusted according to customer requirement. Flow rate set at 6 l/min, can be reduced by the integrated stop valve.



OPTIMUM HYGIENE: automatic detection without hand contact, configurable periodical automatic flushing is pre-set every 24 hours after the last use.



EASY INSTALLATION AND MAINTENANCE: just one screw allows access to all the components (battery, solenoid valve and the filter) without dismantling the tap.



SECURITY: the solenoid valve closes automatically if the battery runs out or the sensor is damaged.



COMPACTNESS: its smaller design blends in easily with its surroundings.



PRESTO®
loves water

SENSAO 8500/8600

The PRESTO SENS AO 8500/8600 sensor urinal valve unit offers a **compact and sturdy design**. The timed flow pre-set at 6 seconds **reduces the delivered flushing volume**. Concealed mounting with 304L stainless steel front plate ensures **protection against vandalism**. Its dual activation mode offers better hygiene thanks to the contactless sensor unit, and better comfort for the user who can trigger the manual override button. The manual activation can also be used in case of daily cleaning routine.



FOR WHICH AUDIENCE?

The PRESTO SENS AO 8500/8600 is the recommended solution for all public sanitary use requiring reliable operation for reasons of hygiene, odour and cleanliness:

- Offices
- Airports
- Stadiums
- Restaurants
- Public swimming pools
- Shopping centres



OPERATION: the periodical flushing is programmable and the automatic detection parameters can be adjusted.



VANDAL-PROOF: concealed mounting with stainless steel anti-vandal 304L front plate (smudge-proof finish).



GREATER EASE OF INSTALLATION AND SIMPLER MAINTENANCE: this pre-assembled product simplifies installation and reduces maintenance time thanks to easy front access.



BENEFITS

PRESTOTEM[®] 2 STYLISH AND SIMPLE



The new PRESTOTEM 2 shower panels present a modern and robust design. They are perfectly adapted to commercial applications with high resistance to intensive uses. These innovative shower panels are simple to use, making installation and service easier, thanks to the wide opening panel and their **removable shower valve plate**.

REVOLUTIONARY REMOVABLE PLATE COMPATIBLE WITH PRESTO TAPS





PRESTO®
loves water

PRESTOTEM 2 FOR WHICH AUDIENCE?

PRESTOTEM 2 is designed for intensive use, with strict sanitary requirements:

- Campsites
- Public swimming pools
- Gyms and sports centres
- Stadiums
- Outdoor accommodations
- Military accommodations

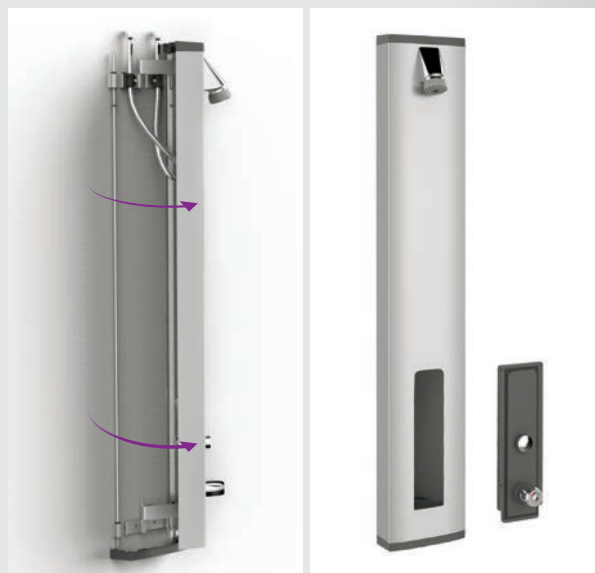

New system with wide opening panel and removable valve plate.

BENEFITS



WATER SAVINGS: self-closing versions prevent waste. PRESTOTEM 2 is also available in S® anti-blocking version making continuous flow impossible.



OPTIMIZED AND SIMPLIFIED SERVICE: the opening panel provides full access to the taps and shower head without dismantling. The revolutionnary removable valve plate brings significant savings in terms of storage space and management time if this equipment is put away for winter storage. Maintenance can also be carried out elsewhere.



QUICK AND COST EFFECTIVE INSTALLATION: light-weight frame with hinge and door opening system makes it easy for one person to install the equipment alone. For renovations, the panel and the adjustable space between axes make it possible to cover up where a first-generation PRESTOTEM was installed.



COMPATIBILITY: With PRESTOTEM 2, you can change tap type as required; simply change the removable plate and it is compatible with PRESTO taps (MasterMix, TOUCH, PRESTO 50 etc.).

MasterMix[®]

CONTROL RISK



The new generation of SANIFIRST[®] thermostatic mixers makes use of unique patented MasterMix technology, which limits the risks of burns and infection for both patients and care workers.

Now available as a whole collection:

- **washbasins** (with or without pull-out spray shower head)
- **wall-mounted showers** (top and bottom outlet)
- **shower tablets** (mechanical and TOUCH[®] sensitive)
- **PRESTOTEM[®] 2 shower panels** (mechanical and TOUCH sensitive)

MasterMiX[®]



MasterMix FOR WHICH AUDIENCE?

The MasterMix is designed for healthcare establishments and facilities for the elderly or young children:

- Hospitals
- Nursing homes
- Nurseries
- Clinics
- Retirement homes
- Maternity units



Wall-mounted version



Shower tablet version

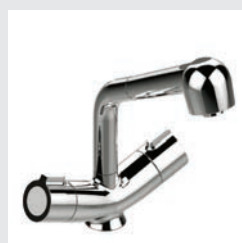
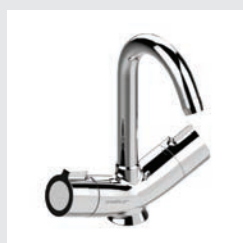

Single-hole version



Shower panel version

BENEFITS



PROTECTS AGAINST BACTERIAL GROWTH: MasterMix technology prevents any intercommunication between DHW (domestic hot water) and DCW (domestic cold water), eliminating the need for check valves, which are very often the source of intercommunication.



PROTECTS AGAINST BURNS: the temperature is controlled since the thermostatic cartridge prevents any water flow in the event of instant shut-off (in accordance with French standard NF EN 1111). The dual temperature limiters will not deliver pre-mixed water above 38°C or 41°C. The body remains cold.



EASY TO MAINTAIN: the thermostatic cartridge can be changed without shutting off the water. The mixer simply needs to be left in the "off" position.

CUSTOMISE YOUR TAPS STAND OUT FROM THE CROWD

Express your originality with **customised taps** that will help you stand out and **highlight your clients' brands**.

Choose the colour of your taps, and **add your logo or text** to numerous PRESTO products.



i

3 TYPES OF CUSTOMISATION AVAILABLE

COLOURED COVER/LEVER



LASER MARKING



COLOUR PAD PRINTING



HOW TO CUSTOMISE PRESTO PRODUCTS

- 1 Select the product you want to customise and the type of customisation you require.

	WASHBASIN			SHOWER		FLUSH VALVE	URINAL VALVE
	PRESTO NEO® Duo	NEW TOUCH®	SO'O®	ALPA concealed	P50 B / P500 S® B concealed	P1000 XL single and dual volume + P7000XL	SENSAO® 8500-8600
Coloured cover/lever	✓	✓	✓	-	-	-	-
Laser marking	-	✓	✓	✓	✓	✓	✓
Colour pad printing	-	✓	✓	✓	✓	✓	✓

- 2 Specify the position and size of the logo/text. If a logo is required, provide a high-definition image.
- 3 Indicate the quantities required.
- 4 Send your request for information/a quote by email to serviceclient@presto.fr or contact your sales representative.

sanifirst

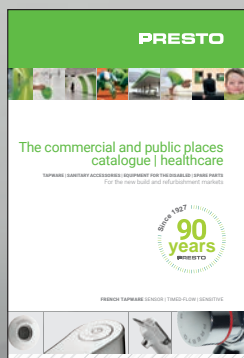

i Check out our tapware solutions for healthcare facilities in the commercial and public places catalogue | healthcare.

WASHBASIN

PRESTO NEO®

Deck-mounted mixer tap

NEW

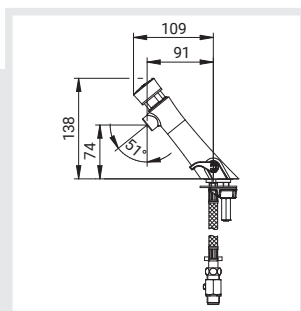

| 3 l/min | Ø 3/8" | 7 s | Temperature limiter |

PRESTO NEO® MIXER TAP

PRESTO GREEN

Straight stop valves – 7 s

68401

PRESTO NEO® – 65 mm – 95 mm – 150 mm PROJECTION

Single wall-mounted tap

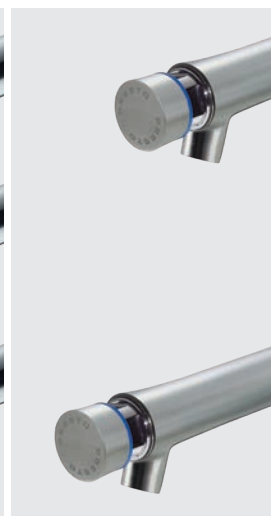

| 3 l/min | Ø 1/2" | 7 s | 75 °C |

PRESTO NEO® CHROME-PLATED BRASS

65 mm PROJECTION SINGLE TAP

PRESTO GREEN

Cold water – 7 s

66005

95 mm PROJECTION SINGLE TAP

PRESTO GREEN

Cold water – 7 s

66015

150 mm PROJECTION SINGLE TAP

PRESTO GREEN

Cold water – 7 s

66025

PRESTO NEO® STAINLESS STEEL

65 mm PROJECTION SINGLE TAP

PRESTO GREEN

Cold water – 7 s

66030

150 mm PROJECTION SINGLE TAP

PRESTO GREEN

Cold water – 7 s

66035

PRESTO NEO® DUO S®

Deck-mounted mixer tap

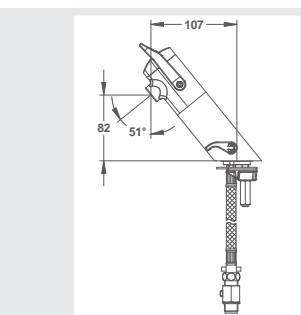
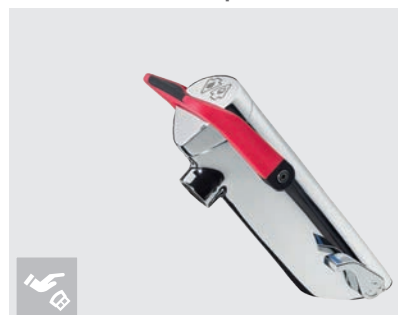

| 3 l/min | Ø 3/8" | 7/11 s | Temperature limiter |

PRESTO NEO® DUO MIXER TAP

DUAL TIMED-FLOW

S® anti-blocking system
7/11 s – 3 l/min



68052



68070



68093

PRESTO NEO® DUO S®

Single wall-mounted tap

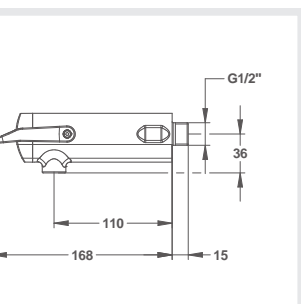

| 3 l/min | Ø 1/2" | 7/11 s | 75 °C |

PRESTO NEO® DUO SINGLE TAP

DUAL TIMED-FLOW

Cold or hot water
S® anti-blocking system
7/11 s – 3 l/min



64708



64734



64764

PRESTORIZON® TAP WITH BUILT-IN ELECTRONICS	
WITH BUILT-IN 9 V LITHIUM BATTERY	
With built-in battery and solenoid valve	52041

PRESTORIZON®

Wall-mounted tap with built-in battery and solenoid valve

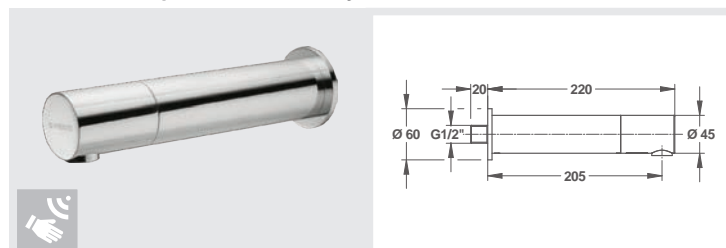

| 3 l/min | Ø 1/2" | 24h duty flush | CE |

VOLTA® SINGLE TAP	
WITH BUILT-IN 6V CRP2 LITHIUM BATTERY	
Straight stop valve	55060
WITH 230 V AC / 7 V DC IP65 POWER SUPPLY	
Straight stop valve	55050

VOLTA®

Single deck-mounted tap

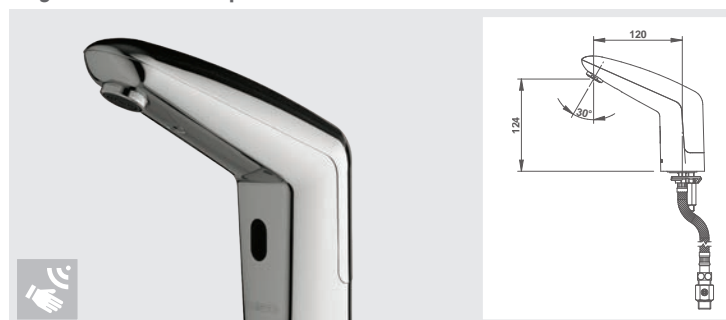

| 3 l/min | Ø 3/8" | 75°C | CE |

SO'O® MIXER TAP	
WITH BUILT-IN 6V CRP2 LITHIUM BATTERY	
Straight stop valves	● Chrome-plated cover 56200
WITH 230 V AC / 7 V DC IP65 POWER SUPPLY	
Straight stop valves	● Chrome-plated cover 56210

SO'O®

Deck-mounted mixer tap

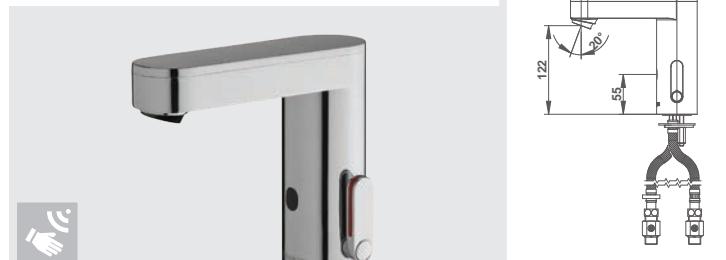

| 3 l/min | Ø 3/8" | Temperature limiter | CE |

NEW TOUCH® MIXER TAP	
WITH BUILT-IN 6V CRP2 LITHIUM BATTERY	
Straight stop valves	● Chrome-plated cover 56603
NEW TOUCH® MIXER TAP	
WITH 230 V AC / 7 V DC IP65 POWER SUPPLY	
Straight stop valves	● Chrome-plated cover 56605

NEW TOUCH®

Deck-mounted mixer tap



| 3 l/min | Ø 3/8" | 6 s | Temperature limiter |

SHOWER

DL 400 SE®

Single tap

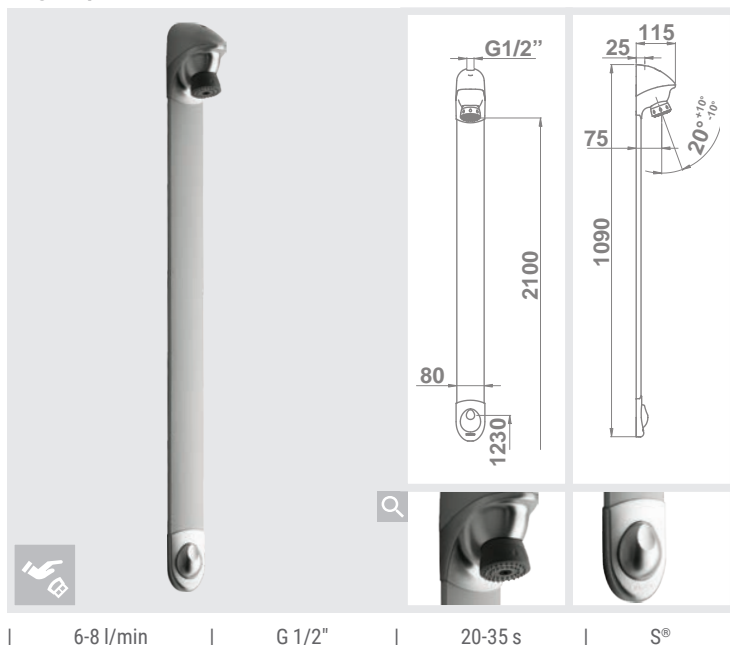

DL 400 SE® SINGLE TAP

Straight stop valves – 20-35 s
Ø 1/2" – **NF/I***

27400

Angled stop valve – 20-35 s
Ø 1/2" – **NF/I***

Satin
grey
finish

27402

LEGIONELLA VERSION

Straight stop valves – 20-35 s
Ø 1/2" – **NF/I***

27424

i Legionella versions must have a remote triggering solution.

* Certified products **NF**

DL 400 E TOUCH®

Single tap

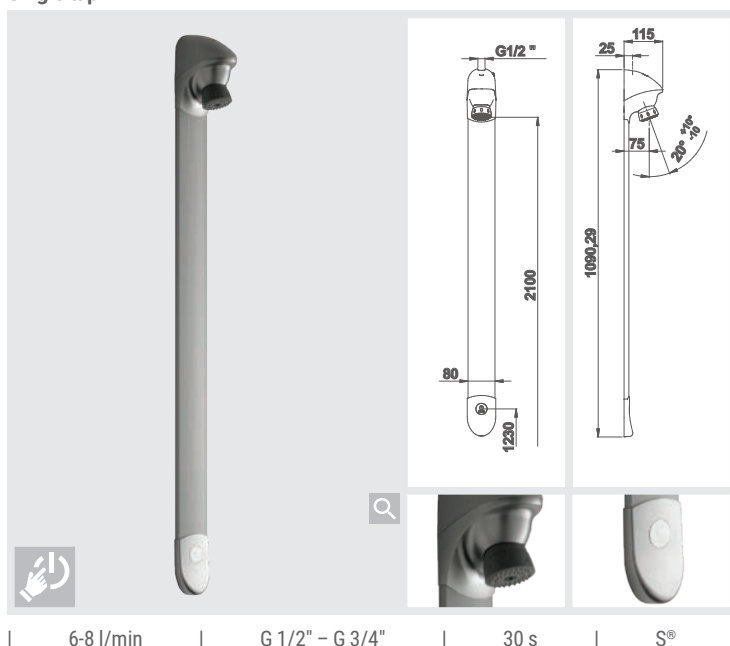

DL 400 E TOUCH® SINGLE TAP

Straight stop valves – 30 s
Ø 1/2"

Satin grey
finish

27432

PRESTO ALPA® – ONLY

Mixer tap



| 8 l/min | G 3/4" – G1/2" | 20-35 s | S® |

PRESTO ALPA® – ONLY MIXER TAP

Adjustable elbow connector	Black knob	35013
20-35 s – 8 l/min		

PRESTO ALPA® – ONLY

Panel mounted mixer tap



| 8 l/min | G 3/4" | 20-35 s | S® |

PRESTO ALPA® – ONLY PANEL MOUNTED MIXER TAP

For mounting on thin partitions 20-35 s – 8 l/min	Chrome-plated knob	35936
	Black knob	35906

PRESTO ALPA® / PRESTO ALPA S®

Concealed mixer tap in watertight case / Anti-blocking system concealed mixer tap in watertight case



| 8 l/min | G 1/2" | 20-35 s | S® |

PRESTO ALPA® ALPA® WATERTIGHT CONCEALED CASE

20-35 s – 8 l/min	Chrome-plated knob	35190
-------------------	--------------------	--------------

PRESTO ALPA S® CONCEALED MOUNTED ANTI-BLOCKING SYSTEM MIXER TAP IN A WATERTIGHT CASE

20-35 s – 8 l/min	Chrome-plated knob	35192
-------------------	--------------------	--------------

PRESTO 50 B – CONCEALED

Single tap for concealed fitting with vandal-proof fastening

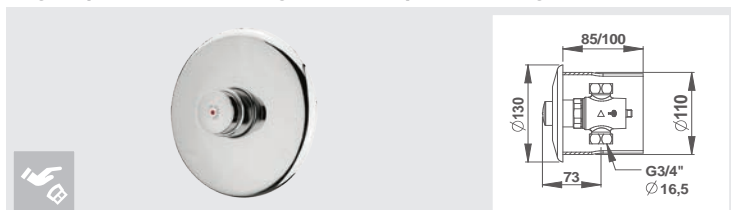

| 8 l/min | G 3/4" | 20-35 s | 75 °C |

PRESTO 50 B – CONCEALED SINGLE TAP FOR CONCEALED MOUNTING WITH VANDAL PROOF FIXING

With vandal proof rosette Installation template – NF/1*	38222
--	--------------

* Certified products 

SHOWER



PRESTOTEM® 2 P50 TM⁽¹⁾
THERMOSTATIC SHOWER PANEL WITH TIMED-FLOW
PRESTO 50 TAPWARE

Top or rear water inlet with shower head **a** 88800

Top or rear water inlet with hand-held shower 88802

LEGIONELLA VERSION
Top or rear water inlet with shower head 88804

PRESTOTEM® 2 P50 TM REVERSER
THERMOSTATIC SHOWER PANEL WITH TIMED-FLOW PRESTO
50 TAPWARE AND REVERSER

Top or rear water inlet **b** 88806

i Legionella versions must have a remote triggering solution.

* For rear water inlet, we recommend to use the adaptation kit 91026.

(1) TM: thermostatic mixer.

PRESTOTEM® 2 P50 TM⁽¹⁾/P50 TM REVERSER

Thermostatic shower panel with timed-flow PRESTO 50 tapware with or without reverser

NEW



| 6 l/min | G 1/2" | 20-35 s | 75 °C |

PRESTOTEM® 2 ALPA
SHOWER PANEL WITH ALPA® SELF-CLOSING MIXER TAP

Top or rear water inlet with shower head **c** 88808

Top or rear water inlet with hand-held shower **d** 88810

PRESTOTEM® 2 ALPA S®
SHOWER PANEL WITH ALPA S SELF-CLOSING ANTI-
BLOCKING SYSTEM MIXER TAP

Top or rear water inlet and shower head 88812

* For rear water inlet, we recommend to use the adaptation kit 91026.

PRESTOTEM® 2 ALPA/ ALPA S®

Shower panel with ALPA/ ALPA S® self-closing mixer tap

NEW



| 6 l/min | G 1/2" | 20-35 s | 75 °C |

CENTRALISED MIXING VALVE

THERMOSTATIC SAFETY REGULATOR

Internal temperature blocker

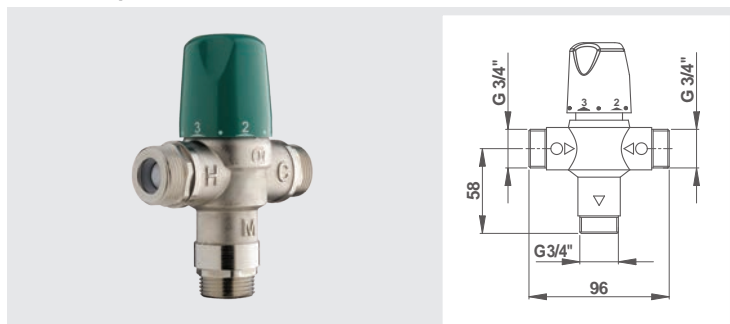

| 5-57 l/min | G 3/4" | Anti-scald | 75 °C |

THERMOSTATIC SAFETY REGULATOR WITH INTERNAL TEMPERATURE-BLOCKING

G 3/4" - inlets and outlet
From 30 to 65 °C – Flow rate: 57 l/min
at 3 bars

29002

THERMOSTATIC SAFETY REGULATOR

38 °C temperature limiter, can be deactivated



| 4-30 l/min | G 3/4" | Anti-scald | 75 °C |

THERMOSTATIC SAFETY REGULATOR WITH 38 °C TEMPERATURE LIMITER THAT CAN BE DE-ACTIVATED

G 3/4" - inlets and outlet
From 20 to 50 °C – Flow rate: 30 l/min
at 3 bars

29003

THERMOSTATIC SAFETY REGULATOR

Internal temperature blocker

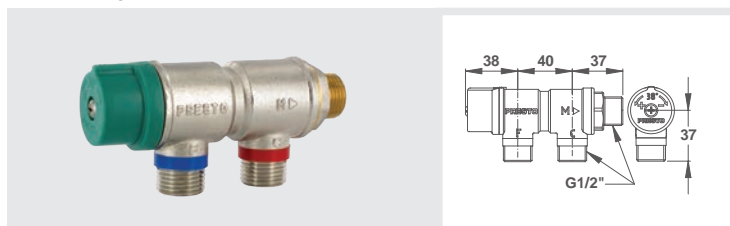

| 4-43 l/min | G 1/2" | Anti-scald | 75 °C |

THERMOSTATIC SAFETY REGULATOR WITH INTERNAL TEMPERATURE-BLOCKING

Inlets and outlet – G 1/2"
From 20 to 50 °C – Flow rate: 43 l/min
at 3 bars

29006

THERMOSTATIC SAFETY REGULATOR

Internal temperature blocker

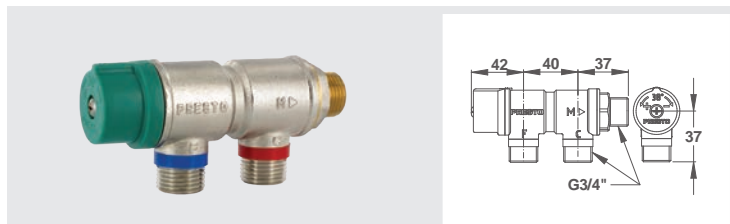

| 6-47 l/min | G 3/4" | Anti-scald | 75 °C |

THERMOSTATIC SAFETY REGULATOR WITH INTERNAL TEMPERATURE-BLOCKING

G 3/4" - inlets and outlet
From 20 to 50 °C – Flow rate: 47 l/min
at 3 bars

29007

i Nickel-plated design - Male inlets - Female outlet
- Swivel nut - Drain cock - G1/4" right or left
mounting allowing filters to be checked.

PRESTO PLP – STAINLESS STEEL

Thermostatic Legionella Touch® shower panel

PRESTO PLP – STAINLESS STEEL

Panel material : 18/10 1.4301 V2A stainless steel
Tapware material: chrome-plated brass
Directional shower head with anti limescale spikes
Programmable timer and rinsing
Size: 1,202 × 202 × 71 mm

LEGIONELLA VERSION

Top water supply **a** Stainless steel 88700

LEGIONELLA VERSION Water supply from the rear Stainless steel finish 88702

NEW

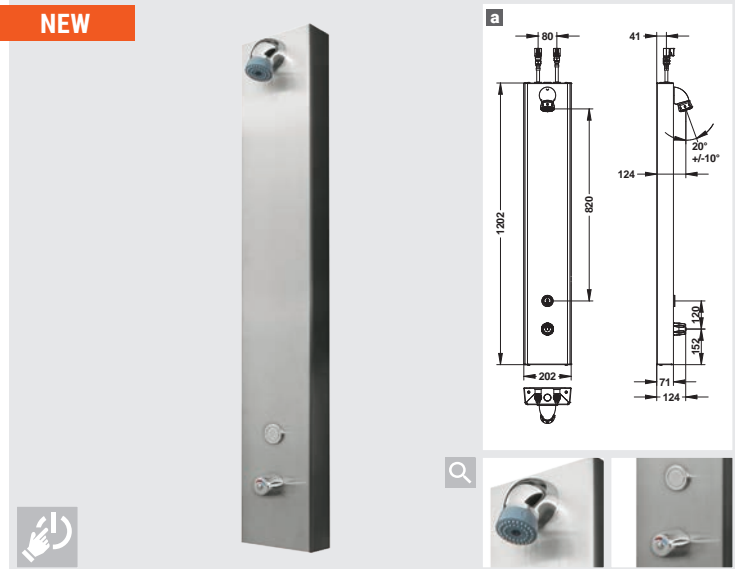

| 10 l/min at 3 bars | G 1/2" | 1 to 5 bars | 75 °C during 30 min |

KEY OPERATED CONTROL BOX

For PLP panels ref. 88700 and 88702 only

88704

FUNCTION

Electricity supply and thermal shock control for 1 to 10 PLP panels.

Programmed thermal shock duration from 1 sec. to 100 hours, factory pre-set to 30 mins.

Programmed drainage after the thermal shock from 1 sec. to 100 hours, factory pre-set to 30 secs.

Input electricity supply: 230 V AC 50/60 Hz.

Output electricity supply: 12 V AC 50/60 Hz.

Thermal shock:

To activate the thermal shock, turn the key to the right. The red indicator lights.

The thermal shock solenoids are activated, the PLP panel is completely disinfected.

After the thermal shock, the panel is rinsed with mixed water, the orange indicator lights.

Drainage is carried out to lower the temperature of the water supply to prevent scalding risks.

NEW

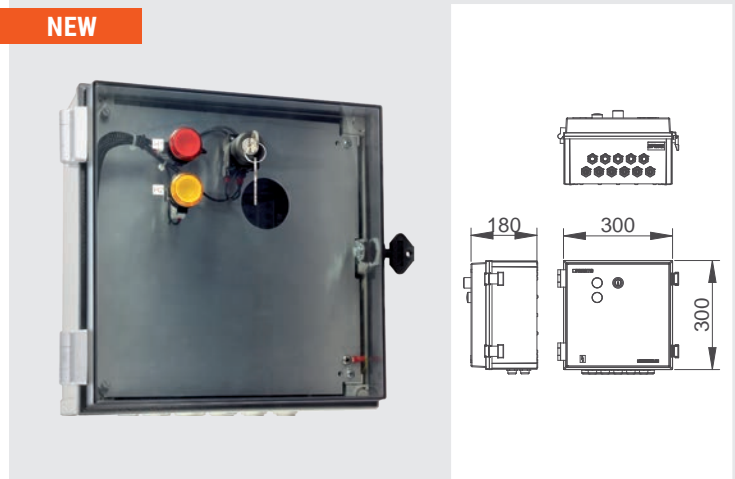

URINAL VALVE

PRESTO 12 / PRESTO 12 FROST PROOF / PRESTO 12 A

In-line and right-angled water inlet

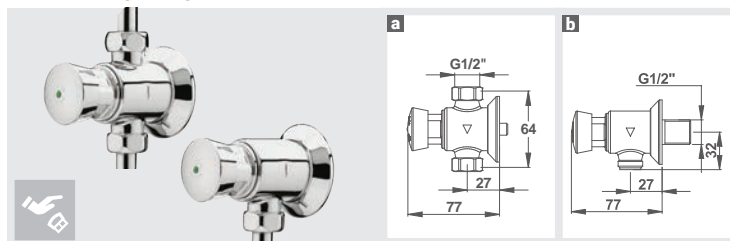

| 9 l/min | G 1/2" | 6 s | vandal proof |

PRESTO 12 IN LINE INLET

With 1 connector – **NF* a** 31001

PRESTO 12 ANTIGEL (FROST PROOF) IN LINE INLET

With 2 connectors 31303

PRESTO 12 A RIGHT-ANGLED INLET

Without connectors – **NF* b** 31707

IN-LINE WATER INLET KIT

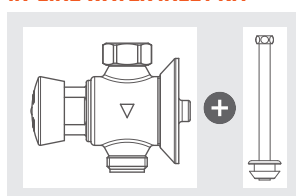

ALLIA®

AUBAGNE 2

COMPLETE KITS In-line water inlet 31993

JACOB DELAFON®

COQUILLE 2

COMPLETE KITS In-line water inlet 31983

EXPOSED SENSÃO 8400N FOR STANDARD BATTERY POWERED URINAL



| 6 l/min | G 1/2" | 8 s | Battery |

SENSÃO® 8400 N

SENSOR URINAL VALVE FOR IN-LINE WATER INLET

In-line water inlet - for standard battery powered urinal 55370

In-line water inlet for siphonic action battery powered urinal 55370

+ 55372*

SENSOR URINAL VALVE FOR RIGHT-ANGLED WATER INLET

Right-angled water inlet - for standard battery powered urinal 55371

Right-angled water inlet - for siphonic battery powered urinal 55371

+ 55372*

* Siphonic pipe for siphonic battery powered urinal.

SENSAO® 8500 CONCEALED BATTERY POWERED	
WITH BUILT-IN 6 V CRP2 LITHIUM BATTERY	
304 L grade brushed stainless steel finish	55610
SENSAO® 8600 CONCEALED MAINS POWER INLET	
230 V AC / 12 V AC TRANSFORMER NOT INCLUDED	
304 L grade brushed stainless steel finish	55612

SENSAO® 8300 CONCEALED - STAINLESS STEEL

Battery or mains power inlet

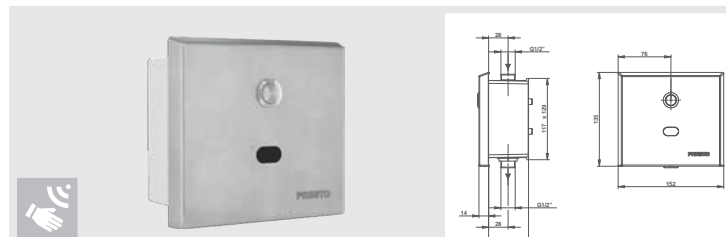

| 8 l/min | G 1/2" | 6 s | Vandal proof |

COMPLETE UNIT FOR BANKS OF URINALS

WITH 230 V AC / 12 V DC SAFETY TRANSFORMER
10 VA - IP65

For all types of urinal **52914**

- i** Configurable flush time from 1 to 10 sec. after the user has left.

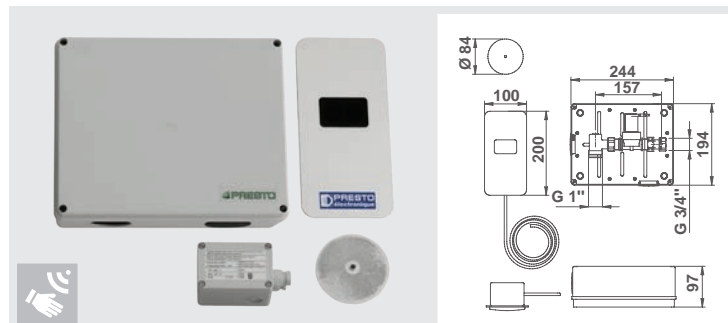
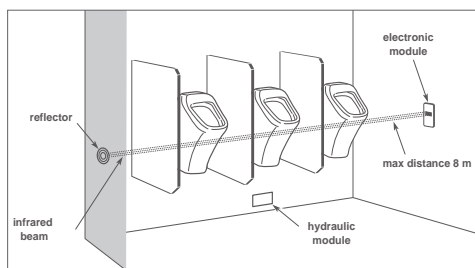

| 104 l/min | Ø 3/4" | 7 s | Transformer |

SENSOR FOR SUSPENDED CEILINGS

Wide field model - 2 to 6 urinals

52454

- i** **SUSPENDED CEILING DETECTION OPERATION**

Pre-rinsing (can be deactivated) when the user enters the detection zone (time equal to half the rinsing time). Rinsing (adjustable from 1 to 20 seconds) is activated 30 seconds after the user leaves. The 30 second timer is reinitialised if a new user arrives during this period, with a maximum duration of 2 minutes after which rinsing is forced (during very busy periods). If a new user arrives during the 20 seconds following rinsing, the pre-rinse is cancelled.

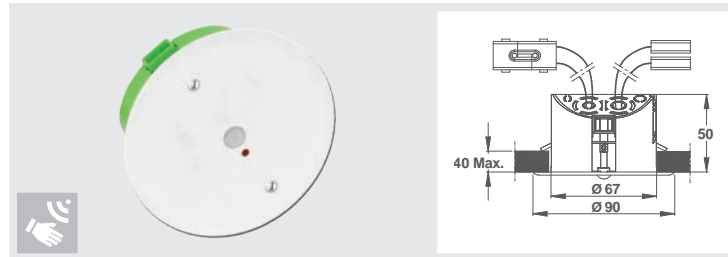

| 25 l/min - 104 l/min | G 1/2" - G 3/4" | 7 s | Transformer |

WIDE FIELD MODEL 2 TO 6 URINALS

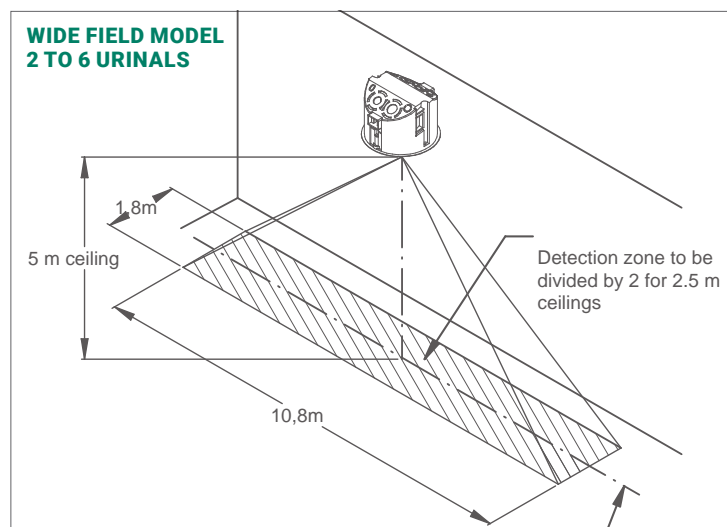

PRESTO 1000 XL E CONCEALED FLUSH VALVE

Vandal-proof front plate Stainless steel finish **14251**

PRESTO 1000 XL E ECO FLUSH VALVE 4L *

Vandal proof front plate **14252**
Stainless steel finish

* please check the compatibility between the valve and the toilet bowl and the evacuation network dimensioning according to the relevant local regulation.

PRESTO 1000 XL E

Concealed flush valve

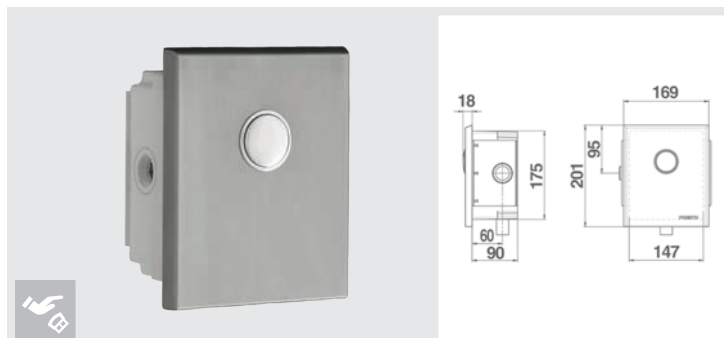

| 6-9 l Standard version | G 3/4" | 6/9 s | outlet Ø 28 mm |
4 l ECO version

PRESTO 1000 XL E DVA

Concealed flush valve

PRESTO 1000 XL E DVA CONCEALED FLUSH VALVE

Adjustable dual volume **14300**
With brushed chrome-plated front plate

PRESTO 1000 XL E DVA ECO FLUSH VALVE 2L/4L *

Adjustable dual volume **14303**
With brushed chrome-plated front plate

* please check the compatibility between the valve and the toilet bowl and the evacuation network dimensioning according to the relevant local regulation.

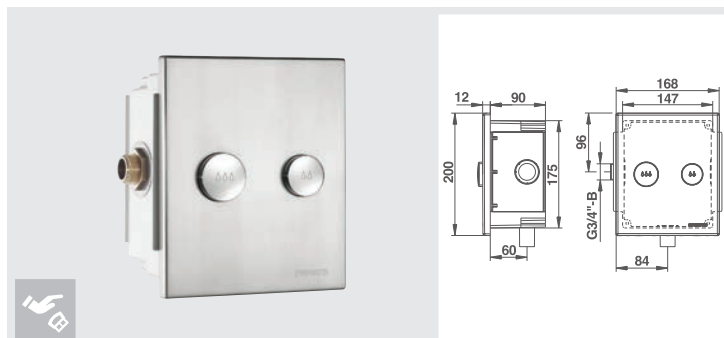

| 3l/6l Standard version | G 3/4" | Dual volume | Large volume: 6/9 s – Small volume: 2/5 s |
2l/4l ECO version

PRESTO 7100 XL

Complete, Concealed flush valve

PRESTO 7100 XL CONCEALED FLUSH VALVE

WITH MAINS 230 V AC / 7 V DC IP55 POWER SUPPLY
TRANSFORMER NOT INCLUDED

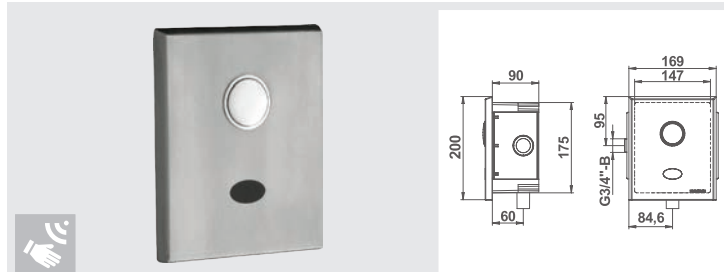
55500

| 6-9 l | G 3/4" | 6/9 s | Mains power supply |

MOUNTING FRAME

SELF-SUPPORTING P 1000 XL S® SYSTEM MOUNTING FRAME

Anti-blocking system and vandal proof tipping control

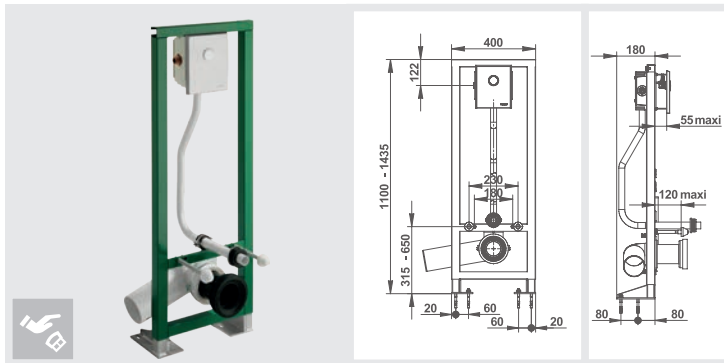

| 6-9 litres | G 3/4" | 6/9 s | S® |

P 1000 XL S® SYSTEM SELF-SUPPORTING MOUNTING FRAME ANTI-BLOCKING SYSTEM AND VANDAL PROOF CONTROL

Brushed stainless steel
control plate
Fitted with a P 1000 XL
concealed direct flush valve

Brushed
stainless
steel finish

18547

SELF-SUPPORTING P 7200 XL OR P 71000 XL S® SYSTEM MOUNTING FRAME

Sensor control and push button

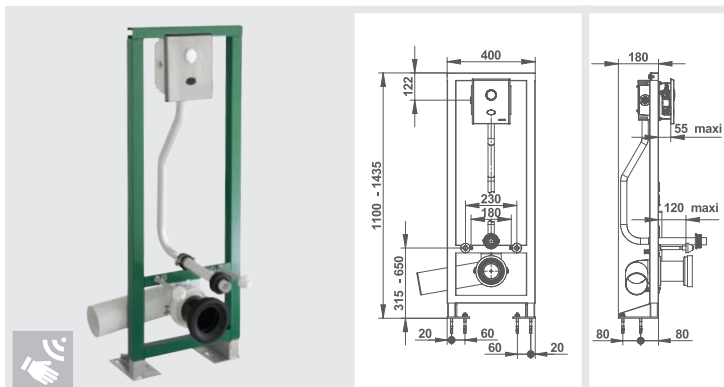

| 6-9 litres | G 3/4" | S® | Mains or battery power supply |

P 7200 XL OR P 7100 XL SENSOR CONTROL AND PUSH BUTTON

BUILT-IN 6V CRP2 LITHIUM BATTERY POWER SUPPLY

18548

MAINS 230 V AC / 7 V DC IP55 POWER SUPPLY
NOT INCLUDED

18549

ADVANTAGES

S® system preventing the system becoming jammed with the water flowing continuously and guaranteeing complete flushing.
Manual by-pass button (keeps the flush operational even if the electricity supply is cut).

Indicative battery life for all PRESTO electronic washbasin sensor taps: 3 years for 125,000 cycles/year (40 cycles/hour for 8 hours every day).

P 1000 XL E DVA S® SYSTEM

ANTI-BLOCKING SYSTEM PUSH BUTTON

Brushed chrome-plated finish front plate,
fingerprint resistant

18460

P 1000 XL A DVA S® SYSTEM

ANTI-BLOCKING SYSTEM PUSH BUTTON

Bright polished chrome-plated front plate
finish

18461

i ADVANTAGES

S® system preventing the system becoming jammed with the water flowing continuously and guaranteeing complete flushing.

P 1000 XL E DVA S® SYSTEM MOUNTING FRAME

Anti-blocking system push-button

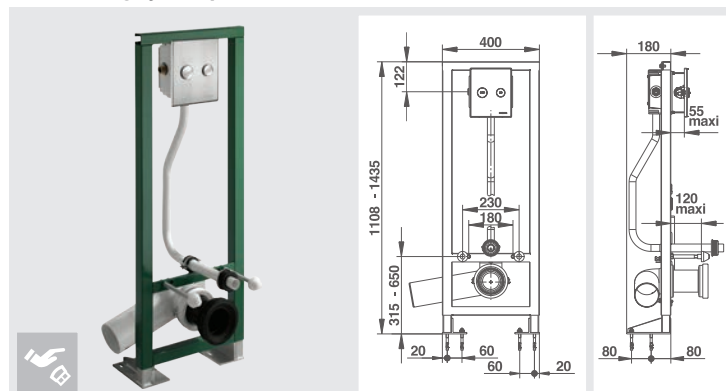

| 3-6 litres | G 3/4" | Dual volume | Large volume: 6/9 s | Small volume: 2/5 s |

MOUNTING FRAME

SELF-SUPPORTING MOUNTING FRAME

With cistern and dual volume tipping control

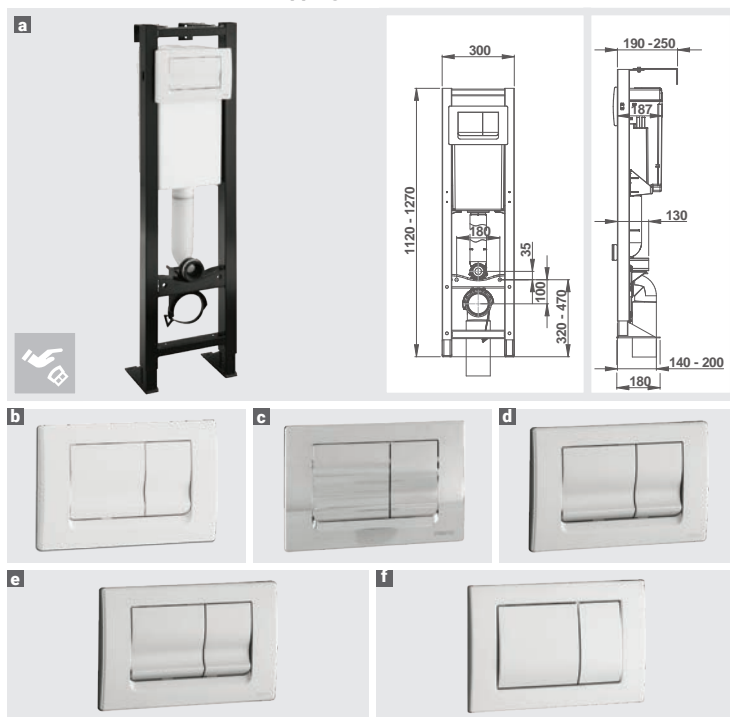

SELF-SUPPORTING MOUNTING FRAME

WITH CISTERN AND DUAL VOLUME TIPPING CONTROL

With white ABS front plate a and b	18593
With bright chrome-plated ABS front plate c	18594
With matt chrome-plated ABS front plate d	18595
With bright chrome-plated metal front plate e	18596
With matt chrome-plated metal front plate f	18597

i Provide a hatch (not supplied) for maintenance access.

SELF-SUPPORTING MOUNTING FRAME

With cistern and dual volume pneumatic control

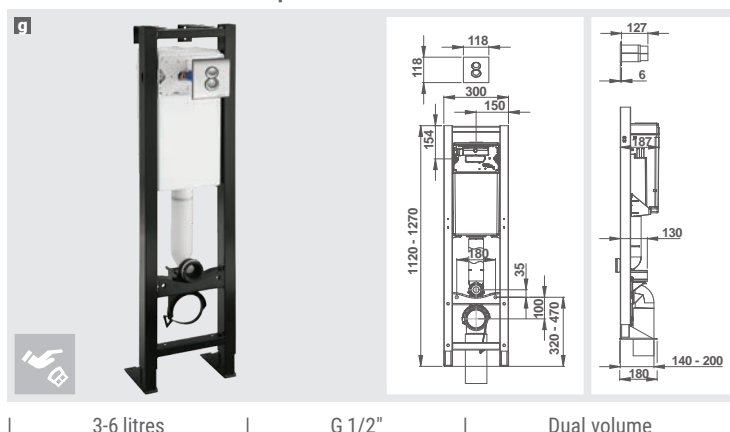

SELF-SUPPORTING MOUNTING FRAME

WITH CISTERN AND DUAL VOLUME PNEUMATIC CONTROL

White finish	18606
Bright chrome-plated finish	18607
Matt chrome-plated finish g	18608

i BENEFITS

Trigger plate that can be built into a fire wall, in compliance with fire safety regulations in establishments open to the public under article C031.

| 3-6 litres | G 1/2" | Dual volume |

MOUNTING FRAME WITH PRESTO 120 B

Timed flow valve

MOUNTING FRAME WITH PRESTO 120 B VANDAL AND ANTI-BLOCKING SYSTEM CONTROL

Vandal-proof front plate

Brushed
stainless
steel finish

18564

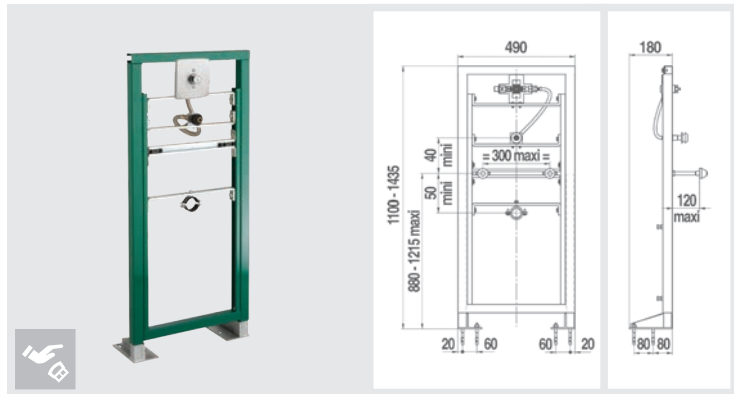

| 9 l/min | G 1/2" | 6 s | Vandal proof |

SANIFIRST - WASHBASIN

SINGLE HOLE THERMOSTATIC WASHBASIN MIXER TAP



SPOUT HEIGHT 191 MM

SINGLE HOLE THERMOSTATIC WASHBASIN MIXER TAP

Smooth internal body

Cartridges : ceramic and thermostatic

No-cross connection between hot and cold water

Dual temperature limiter: 38°C and 41°C

Safety unlocking to perform a thermal shock only by technical staff

Deck-mounted without drainage

75712

**i Anti-scalding safety.
Water pipes safety.
Easy maintenance.**

**CSTB*
APPROVED**

* Scientific and Technical Centre for Building

SINGLE HOLE THERMOSTATIC BABY BATH MIXER TAP



SPOUT HEIGHT 231 MM

SINGLE HOLE THERMOSTATIC BABY BATH MIXER TAP

Pull-out spray head, 2 holes

Smooth internal body

Cartridges : ceramic and thermostatic

No-cross connection between hot and cold water

Dual temperature limiter: 38°C and 41°C

Safety unlocking to perform a thermal shock only by technical staff

Deck-mounted with pull-out spray head

75714

**i Anti-scalding safety.
Water pipes safety.
Easy maintenance.**

**CSTB*
APPROVED**

* Scientific and Technical Centre for Building

MasterMIX®
INSIDE

UNIQUE AND PATENTED TECHNOLOGY
LIMITS THE BACTERIAL PROLIFERATION

THERMOSTATIC MIXER TAP

Cold body with smooth interior
Cartridges :ceramic and thermostatic
No-cross connection between hot and cold water
Dual temperature limiter: 38°C and 41°C
Safety unlocking to perform a thermal shock only by technical staff
Mounting plate to be installed on wall-mounted F1/2 built-in inlets, with integrated stop valves

Exposed version - Downward outlet

75700

i Anti-scalding safety.
Water pipes safety.
Easy maintenance.

CSTB*
APPROVED

* Scientific and Technical Centre for Building

THERMOSTATIC MIXER TAP

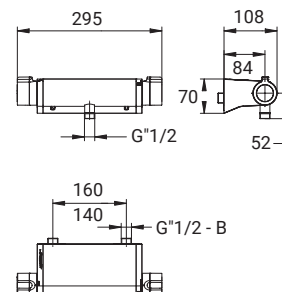
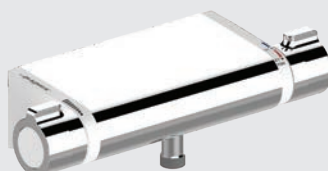

MasterMiX®

THERMOSTATIC MIXER TAP

Cold body with smooth interior
Cartridges :ceramic and thermostatic
No-cross connection between hot and cold water
Dual temperature limiter: 38°C and 41°C
Safety unlocking to perform a thermal shock only by technical staff
Mounting plate to be installed on wall-mounted F1/2 built-in inlets, with integrated stop valves.

Exposed version - Upward outlet

75702

i Anti-scalding safety.
Water pipes safety.
Easy maintenance.

CSTB*
APPROVED

* Scientific and Technical Centre for Building

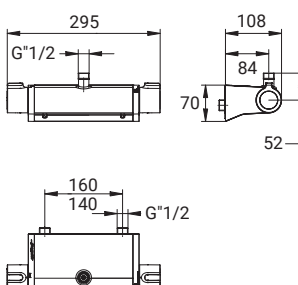
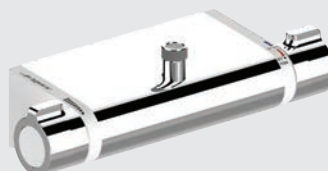

MasterMiX®

ACCESSORIES

Downward swivel spout - Projection 200 mm a	75704
Upward swivel spout - Projection 125 mm b	75705
Long ergonomic flow rate lever c	75706



MasterMiX®
INSIDE

UNIQUE AND PATENTED TECHNOLOGY
LIMITS THE BACTERIAL PROLIFERATION

SANIFIRST - SHOWER

THERMOSTATIC SHOWER TABLET

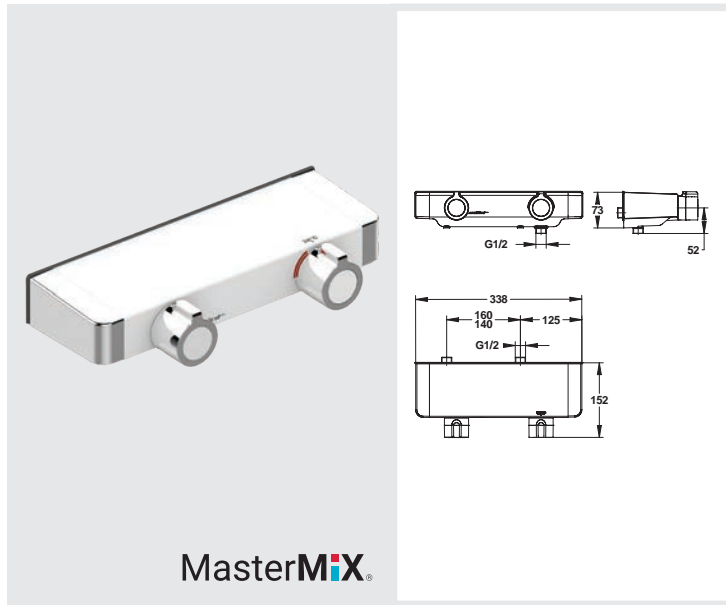

THERMOSTATIC SHOWER TABLET

Cold body with smooth interior
Cartridges : ceramic and thermostatic
No-cross connection between hot and cold water
Dual temperature limiter: 38°C and 41°C
Safety unlocking to perform a thermal shock only by technical staff
Mounting plate to be installed on wall-mounted F1/2 built-in inlets, with integrated 1/4 turn stop valves
Tablet function

Downward outlet

75708

i Anti-scalding safety.
Water pipes safety.
Easy maintenance.

CSTB*
APPROVED

* Scientific and Technical Centre for Building

TOUCH THERMOSTATIC SHOWER TABLET

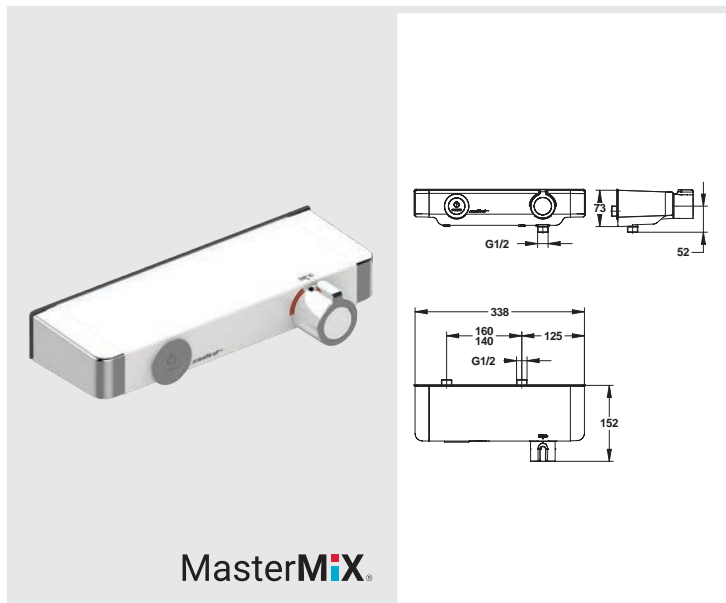

TOUCH THERMOSTATIC SHOWER TABLET

Cold body with smooth interior
Cartridges : ceramic and thermostatic
No-cross connection between hot and cold water
2 solenoid valves: one for hot water, one for cold water
Dual temperature limiter: 38°C and 41°C
Safety unlocking to perform a thermal shock only by technical staff
Mounting plate to be installed on wall-mounted F1/2 built-in inlets, with integrated 1/4 turn stop valves
Tablet function

Downward outlet

75710

i Anti-scalding safety.
Water pipes safety.
Easy maintenance.

CSTB*
APPROVED

* Scientific and Technical Centre for Building

PRESTOTEM®2 TOUCH® MASTERMIX® HEALTHCARE VERSION

THERMOSTATIC SHOWER PANEL WITH PRESTO TOUCH®

Top or rear water inlet* and fixed shower head	88858
Top or rear water inlet* with hand-held shower 	88860

* For rear water inlets, we recommend using adaptation kit 91026

TOUCH PROGRAMME

3 settings can be programmed during the 15 seconds after the power is switched on:

- **the safety time**, corresponding to the use time (in 1-second increments) adjustable from 1 sec to 5 mins;
- **the mandatory rinsing frequency** (in 6-hour increments), pre-set to no mandatory rinse – adjustable from 0 to 63 days;
- **the mandatory rinsing duration** (in 15-second increments), set to 30 seconds by default – adjustable from 15 seconds to 5 minutes.

Settings are adjusted by pressing the button a certain number of times, to which the tap responds by flowing.

PRESTOTEM®2 TOUCH® MASTERMIX®, HEALTHCARE VERSION

Thermostatic shower panel with PRESTO TOUCH®

NEW

Available 2nd semester 2018



PRESTOTEM® 2 DUAL CONTROL MASTERMIX®/REVERSER, HEALTHCARE VERSION

Dual control thermostatic shower panel with or without reverser

NEW

Available 2nd semester 2018

PRESTOTEM® 2 DUAL CONTROL MASTERMIX®, HEALTHCARE VERSION

DUAL CONTROL THERMOSTATIC SHOWER PANEL

Top or rear water inlet* with hand-held shower 	88856
--	-------

PRESTOTEM® 2 DUAL CONTROL MASTERMIX® AND REVERSER, HEALTHCARE VERSION

DUAL CONTROL THERMOSTATIC SHOWER PANEL WITH REVERSER

Top or rear water inlet* and fixed shower head (hand-held shower optional) 	88866
--	-------

* For rear water inlets, we recommend using adaptation kit 91026



COMPLEMENTARY PRODUCTS

ACCESSOIRES

Rear adaptation kit	91026
Hand-held shower kit	91026
Shower gel holder	91037
Winter storage plate	91038

PROFESSIONAL TAPWARE

DECK-MOUNTED ONE-HOLE SINGLE LEVER MIXER TAP

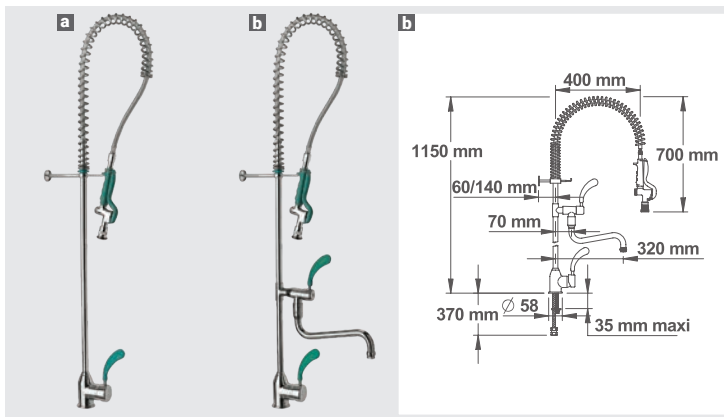

| Ergonomic spray head | 10 l/min on the spray head | NF check valves | Adjustable jet |

DECK-MOUNTED ONE-HOLE SINGLE LEVER MIXER TAP

With adjustable jet spray head a	70552
With adjustable jet spray head and filler tap b	70553

DECK-MOUNTED ONE-HOLE SINGLE LEVER MIXER TAP

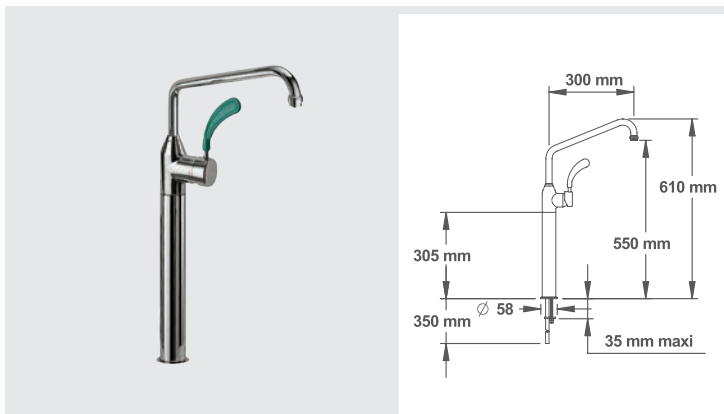

| On hob or ovens | Ceramic cartridge Ø 40 mm | Ergonomic lever | Directional spout |

DECK-MOUNTED ONE-HOLE SINGLE LEVER MIXER TAP

With reinforced giraffe spout Length 300 mm Extension 320 mm Inlet 12/14 welded copper tube	70565
--	-------

DECK-MOUNTED ONE-HOLE MIXER

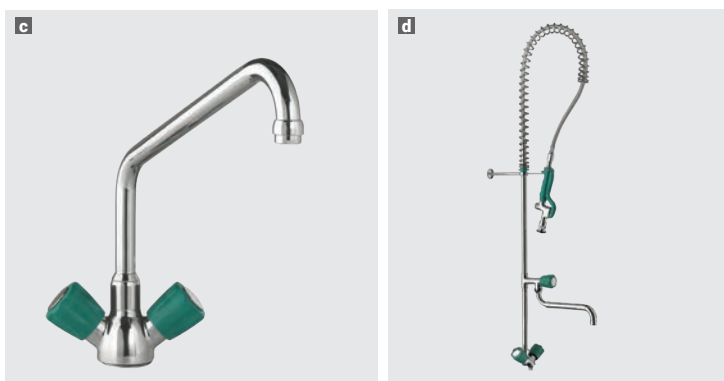

| Ergonomic spray head | 10 l/min on the spray head | Adjustable jet |

DECK-MOUNTED ONE-HOLE MIXER

With reinforced 300 mm long spout c	70562
With adjustable jet spray head and filler tap with telescopic spout d	70551

COMBINED SAFETY SHOWER / EYE WASH

Vertical outlet

COMBINED SAFETY SHOWER / EYE WASH

Shower head with self-draining device
- Eye wash with built-in flow regulator -
Recipient in stainless steel with outlet

85671

i Compliant with the EN 15154-1&2 and ANSI Z 358.1 - 2004 standards

There are 2 tap safety standards:

The European standard EN 15154-1&2.

The American standard ANSI Z 358.1 - 2004.

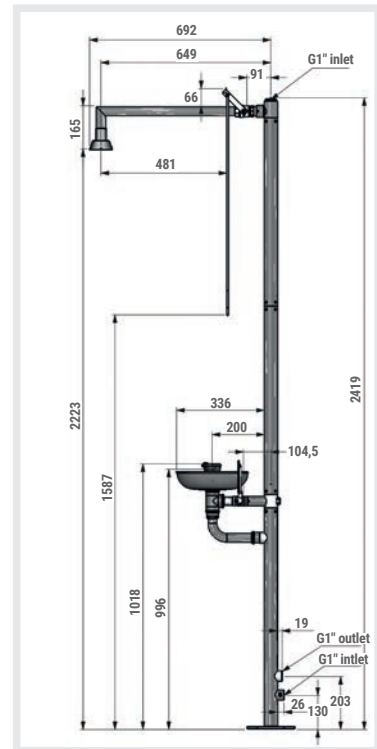

SAFETY SHOWER

Ceiling / wall / surface mounted water supply

SAFETY SHOWER

CEILING WATER SUPPLY

Fixed head - Male 1/2"

85753

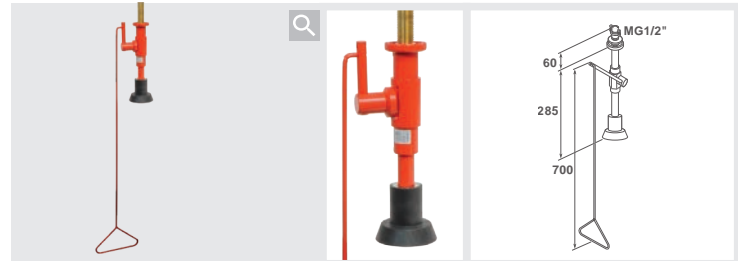

| Minimum pressure 1 bar | Resistant to chemicals | Auto-drainage | 2 kg |

WALL MOUNTED SAFETY EYE WASH

WALL MOUNTED

Single jet model - Trigger control
with G 1/2" hose (15 x 21)

85767

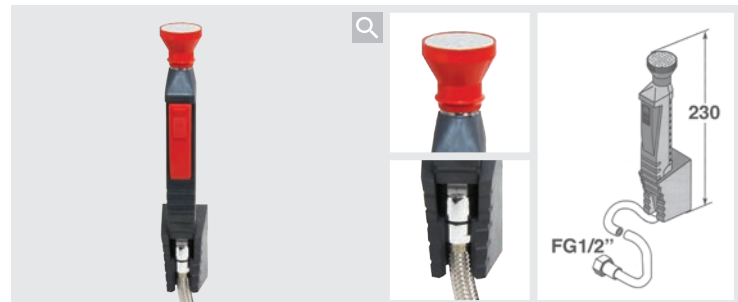

| Minimum pressure 1.5 bars | Resistant to chemicals | G 1/2" | 0.5 kg |

WALL MOUNTED

2 jet model with basin
Lever-operated - G 1/2"

85765

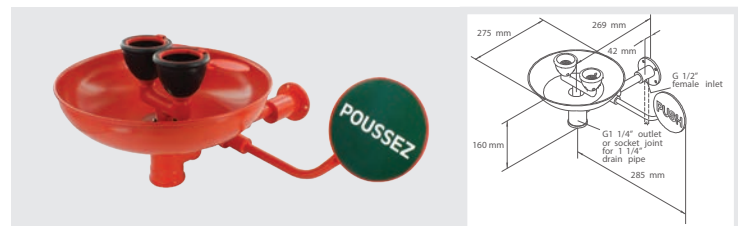

| Minimum pressure 1.5 bars / maximum 10 bars | Resistant to chemicals | 26 l/min |

MOBILITY

Ø 25 mm SUPPORT RAIL

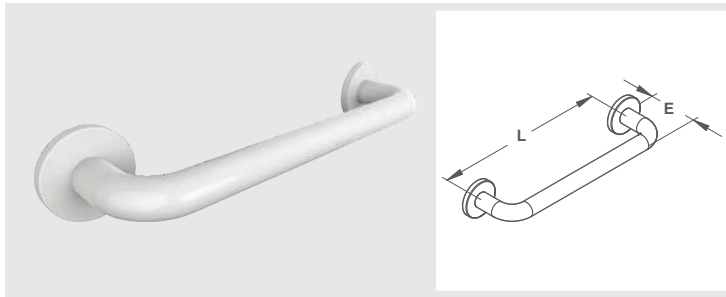

Ø 25 mm SUPPORT RAIL

WHITE EPOXY STEEL FINISH

Straight rail 300 mm	60300
Straight rail 400 mm	60302
Straight rail 500 mm	60304
Straight rail 600 mm	60306

304 GRADE BRUSHED STAINLESS STEEL FINISH

Straight rail 300 mm	60310
Straight rail 400 mm	60312
Straight rail 500 mm	60314
Straight rail 600 mm	60316

Ø 32 mm SUPPORT RAIL

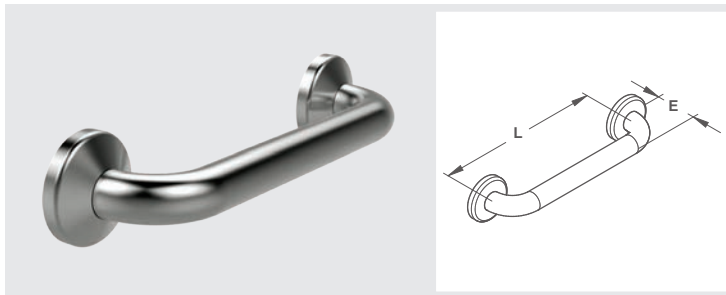

Ø 32 mm SUPPORT RAIL

WHITE EPOXY STEEL FINISH

Straight rail 300 mm	60501
Straight rail 400 mm	60502
Straight rail 500 mm	60305
Straight rail 600 mm	60503
Straight rail 900 mm	60504
Straight rail 1100 mm	60500

304 GRADE BRUSHED STAINLESS STEEL FINISH

Straight rail 300 mm	60311
Straight rail 400 mm	60313
Straight rail 500 mm	60315
Straight rail 600 mm	60317
Straight rail 900 mm	60318
Straight rail 1100 mm	60319

Ø 34 mm SUPPORT RAIL

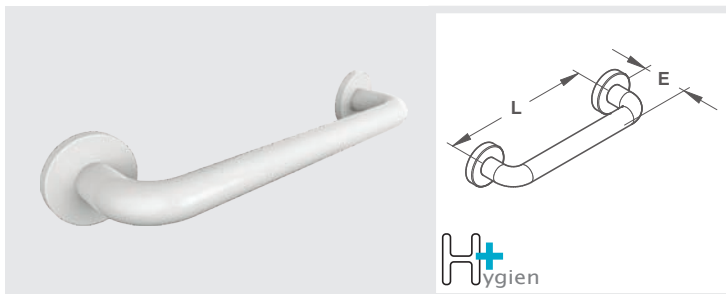

Ø 34 mm SUPPORT RAIL

ANTI-BACTERIAL ABS COATED ALUMINIUM FINISH

Straight rail 300 mm	Hygien +	60451
Straight rail 400 mm	Hygien +	60452
Straight rail 600 mm	Hygien +	60453

ANTIBACTERIAL ABS COATED ALUMINIUM FINISH 3 ANCHOR POINTS

Straight rail 900 mm	Hygien +	60454
Straight rail 1100 mm	Hygien +	60450

PRESTO TIPS

Straight rails can be fitted horizontally (support rails) or sloping at 135°C (raising rails)

135° ANGLED RAIL - Ø 25 mm		
304 GRADE BRUSHED STAINLESS STEEL FINISH		
400 x 400 mm - 3 anchor points		60323
WHITE EPOXY FINISH STEEL		
400 x 400 mm - 3 anchor points		60321
135° ANGLED RAIL - Ø 32 mm		
304 GRADE BRUSHED STAINLESS STEEL FINISH		
400 x 400 mm - 3 anchor points		60324
WHITE EPOXY FINISH STEEL		
400 x 400 mm - 3 anchor points 		60529
135° ANGLED RAIL - Ø 34 mm		
ANTI-BACTERIAL ABS COATED ALUMINIUM		
400 x 400 mm - 3 anchor points Hygien +		60581

135° ANGLED RAIL - Ø 25 mm – Ø 32 mm – Ø 34 mm

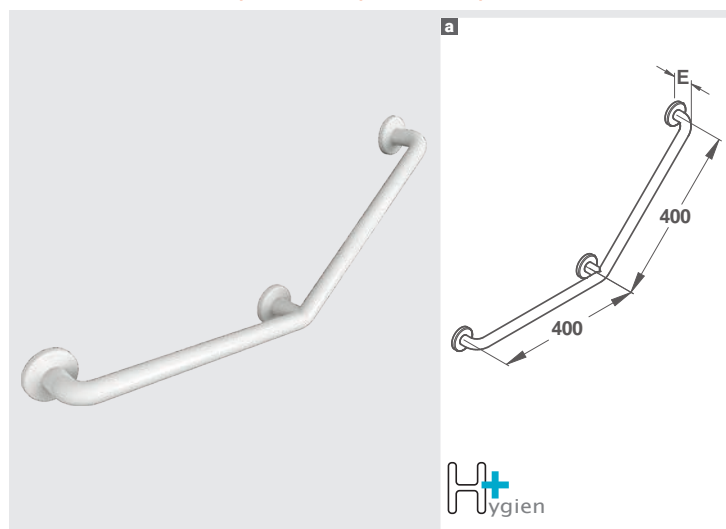

FOLDAWAY RAIL WITHOUT LEG - Ø 34 mm		
WITHOUT TOILET PAPER HOLDER		
ANTI-BACTERIAL ABS COATED ALUMINIUM		
Length 650 mm	Hygien +	60809

FOLDAWAY RAIL WITHOUT LEG - Ø 34 mm – Ø 35 mm

Without toilet paper holder

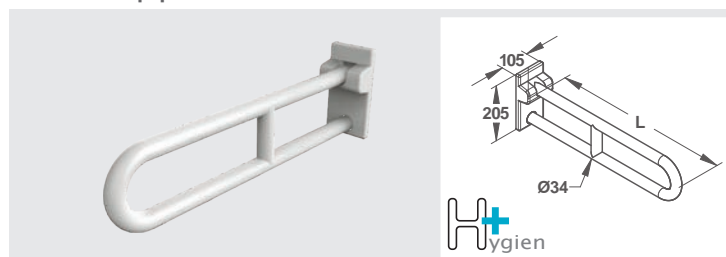

FOLDAWAY RAIL WITH LEG - Ø 35 mm		
WITHOUT TOILET PAPER HOLDER		
304 GRADE POLISHED BRIGHT STAINLESS STEEL		
Length 760 mm		60799

FOLDAWAY RAIL WITH LEG - Ø 34 mm – Ø 35 mm

With toilet paper holder / Without toilet paper holder

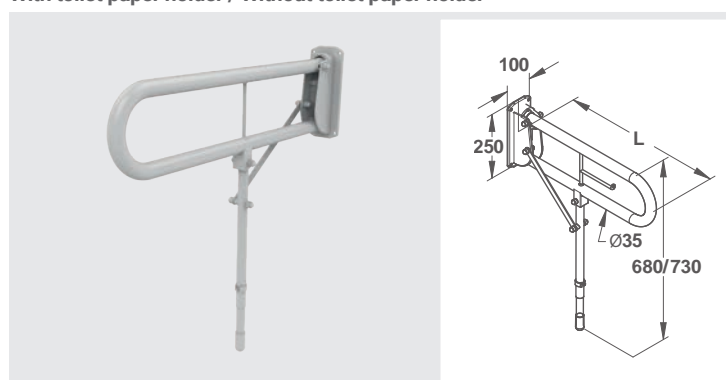

MOBILITY

90° ANGLED RAIL – Ø 32 mm – Ø 34 mm

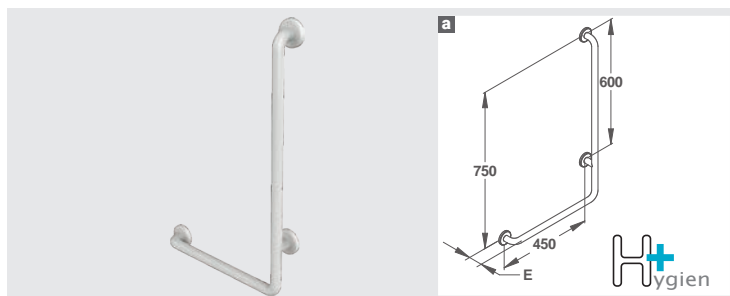

90° ANGLED RAIL - Ø 32 mm		
304 GRADE POLISHED BRIGHT STAINLESS STEEL		
450 x 750 mm – Left side model	a	60759
304 GRADE STAINLESS STEEL WHITE EPOXY FINISH		
450 x 750 mm – Left side model	a	60760
450 x 750 mm – Right side model		60763
90° ANGLED RAIL - Ø 34 mm		
ANTI-BACTERIAL ABS COATED ALUMINIUM		
450 x 750 mm		
Left side model	a	Hygien + 60761
450 x 750 mm – Right side model	Hygien +	60764

CORNER RAIL – Ø 32 mm – Ø 34 mm



CORNER RAIL - Ø 34 mm		
ANTI-BACTERIAL ABS COATED ALUMINIUM		
700 mm x 700 mm		
3 fixture points	Hygien +	60459

RAIL WITH SLIDING BLOCK – Ø 32 mm – Ø 34 mm



WHITE ABS RAIL WITH SLIDING BLOCK – Ø 34 mm		
ANTI-BACTERIAL ABS COATED ALUMINIUM		
Length 1,100 mm	Hygien +	60664

HANG-UP SHOWER SEAT



HANG-UP SHOWER SEAT		
WHITE EPOXY FINISH STEEL		
Hang-up shower seat		60620

CORNER SHOWER RAIL WITH VERTICAL – Ø 32 MM RAIL
304 GRADE STAINLESS STEEL WHITE EPOXY FINISH

Left model	60723
Right model a	60726

CORNER SHOWER RAIL WITH VERTICAL – Ø 32 MM RAIL

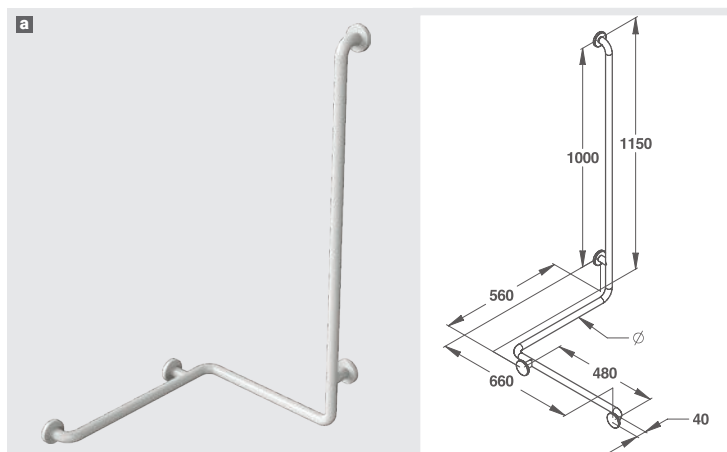

CORNER SHOWER RAIL WITH VERTICAL – Ø 34 mm RAIL
ANTI-BACTERIAL ABS COATED ALUMINIUM

Left model b	Hygien +	60736
Right model c	Hygien +	60739

**CORNER SHOWER RAIL WITH VERTICAL
 Ø 32 mm - Ø 34 mm RAIL**

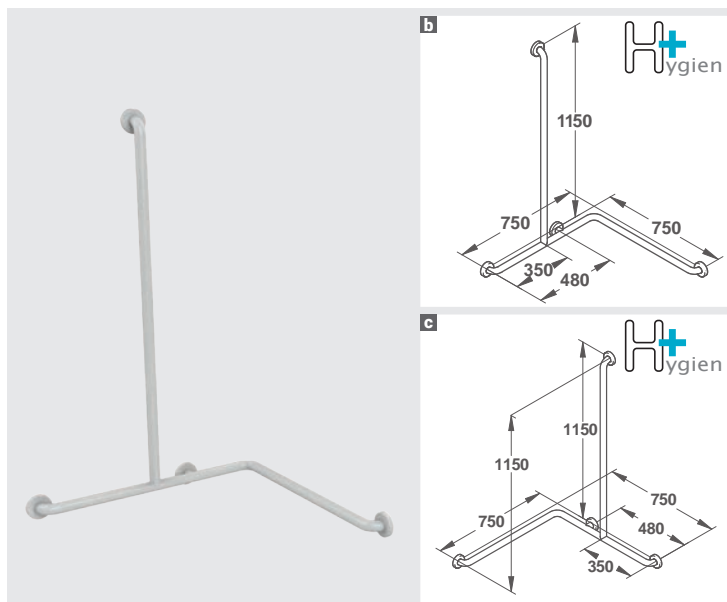

"T" SHAPED SHOWER RAIL - Ø 32 mm
304 GRADE STAINLESS STEEL WHITE EPOXY FINISH

500 mm × 1,150 mm 60753

"T" SHAPED SHOWER RAIL - Ø 34 mm
ANTI-BACTERIAL ABS COATED ALUMINIUM

500 mm × 1,150 mm Hygien + 60754

"T" SHAPED SHOWER RAIL - Ø 32 mm - Ø 34 mm

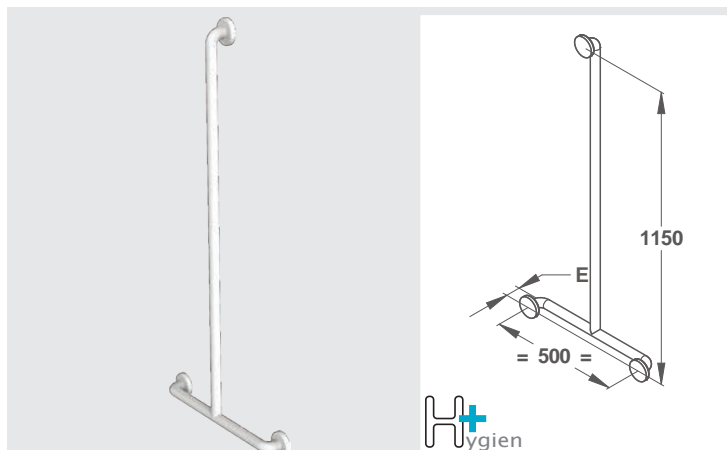

DOWNLOAD OUR
BIM OBJECTS ON
WWW.PRESTOBIM.COM

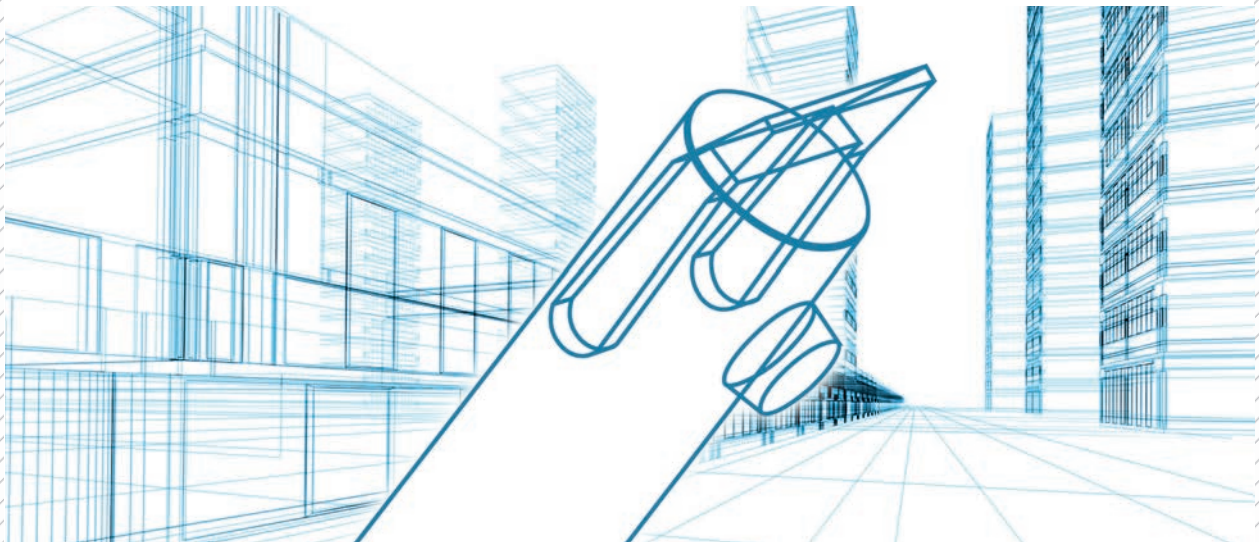

BIM

**PRESTO UPGRADES ITS LIBRARY OF
"INTELLIGENT" OBJECTS AND CONFIRMS
ITS PREMIUM PARTNER PLACE TO
BUILDING PROFESSIONALS**



www.prestobim.com

Credits: © Kruwt/Fotolia - © Lumieres/Fotolia - © Dmitry Nikolaev/Fotolia
© Shariff Che'Lah/Fotolia - © Roman Sigaec/Fotolia - © wildworx/Fotolia
© Tomml/iStock - © Robert Hainer/Fotolia - © Roman Sakhno/Fotolia

CONTACT

INFORMATION, TECHNICAL SUPPORT

Tel.: +33 (0)1 46 12 34 56

Fax: +33 (0)1 47 35 69 82

Email: adv.export@presto.fr

DOWNLOAD CENTRE

Photos, Technical data, Layouts, Tenders

www.prestodatashare.com



www.prestobim.com

PRESTO



LES ROBINETS PRESTO S.A.

7, RUE RACINE

92542 MONTROUGE CEDEX – FRANCE

Tel.: +33 (0)1 46 12 34 56 | Fax: +33 (0)1 40 92 00 12

Email: adv.export@presto.fr

www.presto.fr | www.presto-group.com

