

Floor Drains, Cleanouts, Gratings and Flexible Tube Connectors

S.H.W.®

CAT.NO.39



HAMADA MFG. CO., LTD.

OSAKA

Japan

Introduction

This catalogue contains complete products of HAMADA MFG.CO.,LTD.

Since commencement of export in 1934,"SHW" have supplied products to prestigious projects worldwide. And we meet with an unexceptionally gratifying reception in the trade in approval of quality, most competitive price and correct time of shipment from clients in many overseas markets.



High Quality

"SHW" Floor Drains, Cleanouts, Gratings Flexible Tube Connectors and other products are made of specially selected materials by expert engineers and strict quality control procedures are adhered to.



WITHSTAND LOAD FOR THE PRODUCTS

*Conclusion :

"SHW" Hamada gratings ref : H-397-PF 4" has heavy duty performance and is capable of withstanding a load of upto 100-150 kgs/20cm² without any fracturing to the grating.



Corporate Profile

Firm name	HAMADA MFG.CO.,LTD.
Foundation	April, 1908
Established	22nd June, 1962
Capital	10,000,000JPY(Authorized 12,500,000JPY)
Address	3-2-12 Itachibori Nishi-ku Osaka, Japan (POSTAL CODE) 550-0012
Tel/Fax	+81-6-(6541)-5439/+81-6-(6541)-5954
President	Takeshi Hamada
Trade Mark	(S.H.W.)[®]
URL	http://www.s-h-w.net

Out Line of Corporate History

- 1908** Mr. Shokichi Hamada founded factory under the firm name of "HAMADA SEISAKUSHO" and started production of Faucets, Valves and Cocks. And put "S.H.W." Logo on our products.
"S.H.W." comes from each initial character of Shokichi Hamada Works.
- 1928** Former President, Mr. Isamu Hamada opened Sales branch in Nishi-ku Osaka Japan.
- 1938** Re-organized Sales branch to independent Sales Department.
- 1938** Established under the firm name of EISHIN COMPANY LIMITED in Manchuria. And start to produce Faucet, Floor drain, Valves and Cocks.
- 1943** Established consolidated company of YAMATO VALVE MFG. CO., LTD. based on the firm name of HAMADA SEISAKUSHO by order of the Japanese authorities.
Through enlargement of production facilities, the company supplied military circles with ship parts and other munitions serving the wartime industry until the end of the World War II
- 1945** Major parts of the factory were air-raided and burnt down. But the company started reconstruction promptly after the war.
- 1946** Participated in management KANSAI VALVE CO., LTD.
- 1949** Withdrawal from managing KANSAI VALVE CO., LTD.
- 1950** Changed the firm name to HAMADA VALVE CO., LTD.
- 1962** Changed the firm name to HAMADA MFG. CO., LTD.
- 1997** Moved to New Head office



Model Number Configuration

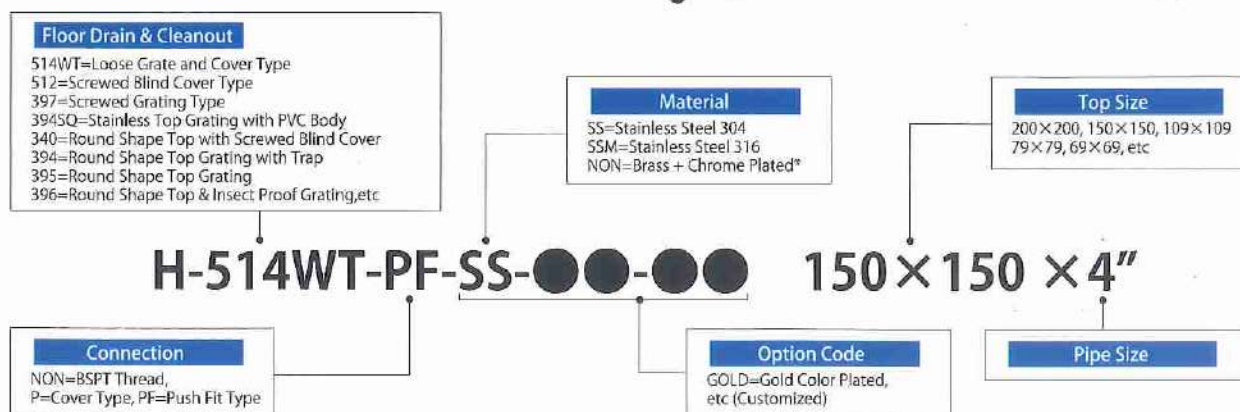

*Step of Chrome Plating: Nickel Plating 15~20 μm(Base Plated) + Chrome Plating 0.25 μm(Finish Plated)

HI-DRAIN

MODEL No. H-515-PF



Stylish & Elegant
"HI-DRAIN"

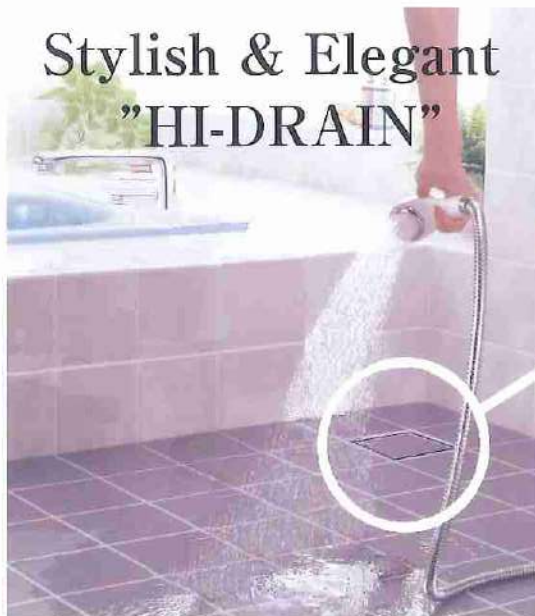

NEW STYLE FLOOR DRAIN

This is the new style Floor Drain which adds a stylish & elegant touch to the interior. The whole floor will be decorated harmoniously. Simple and beautiful design will be attained.

Special Feature

HI-DRAIN blends into other tiles, which makes the floor **Stylish & Elegant**! HI-DRAIN is the high-end model of floor drain.

Purposes



Hotel



Clubhouse



Hospital



Kitchen, Restaurant



Bathroom



Entrance

2" or 2-1/2" outlet

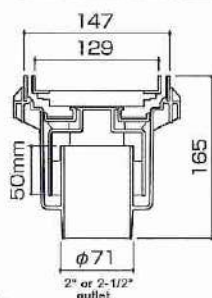
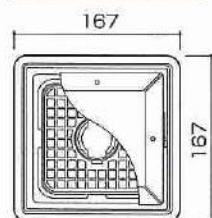

4" outlet

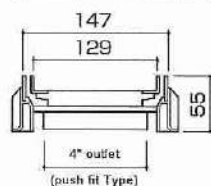
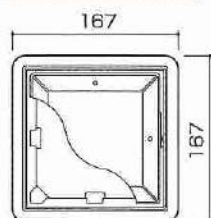

ESCUTCHEON

SS304
2mm thickness

BODY

Same size as 150mm square tile.

GRATING

Catch the hair, sludge & garbage. It is removable for maintenance.

TRAP

Trap depth is 50mm.
Cut down the smell & insect.
(2", 2-1/2" outlet type only)

OUTLET

4" outlet, 2" & 2-1/2" outlet

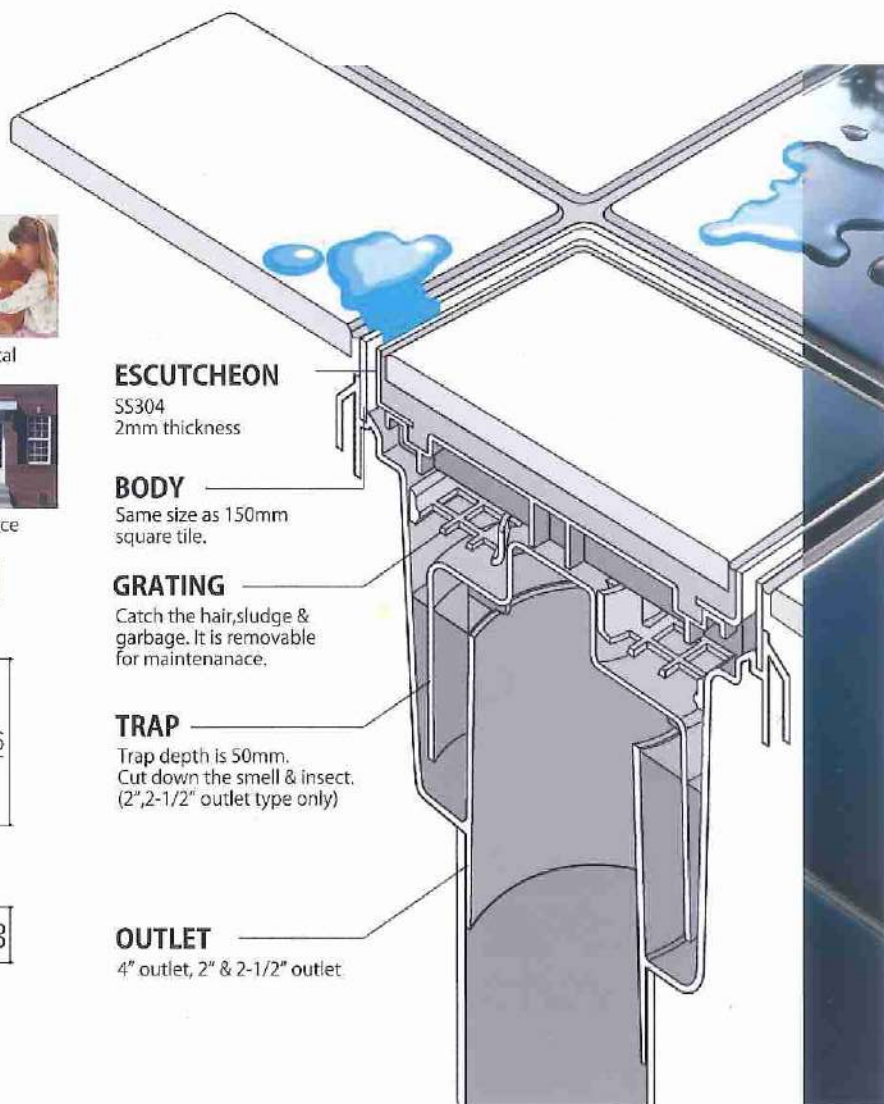

TR-Series

GRATING & CLEANOUT WITH P-TRAP



**H-397-P (PF)-TR
Grating Type**

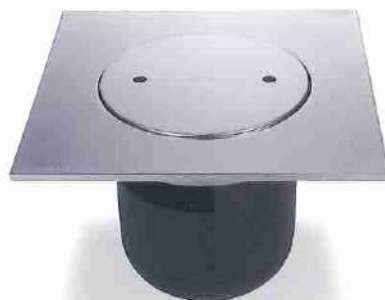

**H-512-P (PF)-TR
Cleanout Type**

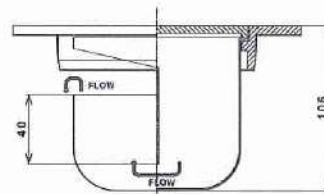

Specification

Part	Material / Description
Grating / Cleanout	Brass + Chrome plated or Stainless Steel
P-Trap	ABS
Hanger of P-trap	Stainless Steel
Size	150mm x 150mm x 4"outlet

1 SHW "TR-Series" keeps clean environment !

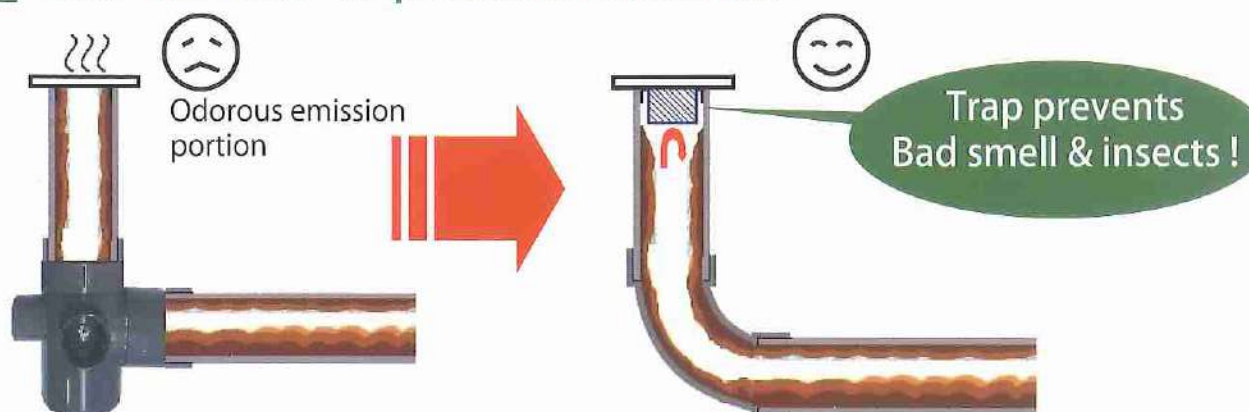

2 SHW "TR-Series" greatly expands piping design !



3 Removable Trap



H-514^{SERIES}

COVER TYPE CONNECTION

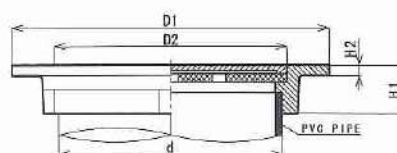
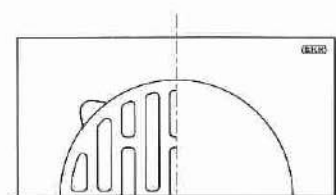

P TYPE

Dimensions. (mm)

	d	D1	D2	H1	H2
63sq x 40	43.5	63	48	20	2.5
79sq x 50	56.5	79	59	20	2.5
109sq x 75	82.5	109	86	21	2.5
150sq x 50	110.5	150	59	20	2.5
150sq x 75	82.5	150	86	21	4
150sq x 100	110.5	150	110	23	2.5
200sq x 100	110.5	200	110	36	4
200sq x 150	160.5	200	162	36	4

BRASS MADE + GOLDEN COLOR PLATED

H-514-WT-P-GOLD

BRASS MADE + CHROME PLATED

H-514-WT-P

STAINLESS STEEL MADE + POLISHED

H-514-WT-P-SS

※SS316 is available.

PUSH-FIT TYPE CONNECTION

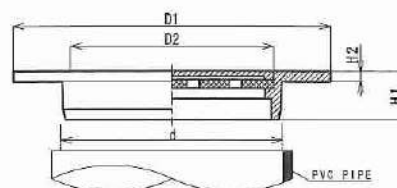
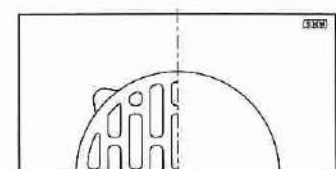

PF TYPE

Dimensions. (mm)

	d	D1	D2	H1	H2
63sq x 40	40	63	37	20	2.5
79sq x 50	51	79	47	20	2.5
109sq x 75	77	109	73	21	2.5
150sq x 100	103	150	96	23	2.5
200sq x 100	103	200	96	23	2.5
200sq x 150	146	200	137	36	4

BRASS MADE + CHROME PLATED

H-514-WT-PF

STAINLESS STEEL MADE + POLISHED

H-514-WT-PF-SS

※SS316 is available.

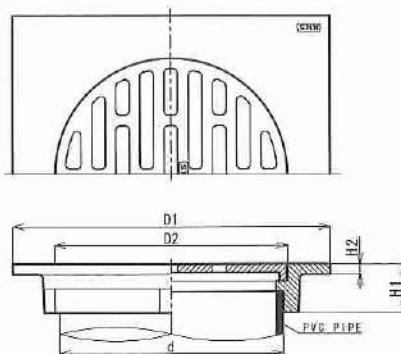
H-397 SERIES**COVER TYPE CONNECTION****P TYPE**

Dimensions.

(mm)

	d	D1	D2	H1	H2
63sq x 40	43.5	63	48	20	2.5
79sq x 50	56.5	79	59	20	2.5
109sq x 75	82.5	109	86	21	2.5
150sq x 50	110.5	150	59	20	2.5
150sq x 75	82.5	150	86	21	4
150sq x 100	110.5	150	110	23	2.5
200sq x 100	110.5	200	110	36	4
200sq x 150	160.5	200	162	36	4

BRASS MADE + GOLDEN COLOR PLATED

H-397-P-GOLD

BRASS MADE + CHROME PLATED

H-397-P

STAINLESS STEEL MADE + POLISHED

H-397-P-SS

※SS316 is available.

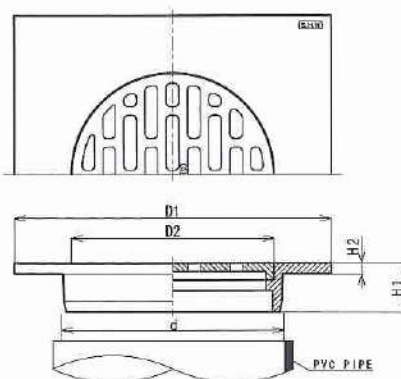
PUSH-FIT TYPE CONNECTION**PF TYPE**

Dimensions.

(mm)

	d	D1	D2	H1	H2
63sq x 40	40	63	37	20	2.5
79sq x 50	51	79	47	20	2.5
109sq x 75	77	109	73	21	2.5
150sq x 100	103	150	96	23	2.5
200sq x 100	103	200	96	23	2.5
200sq x 150	146	200	137	36	4

BRASS MADE + CHROME PLATED

H-397-PF

STAINLESS STEEL MADE + POLISHED

H-397-PF-SS

※SS316 is available.

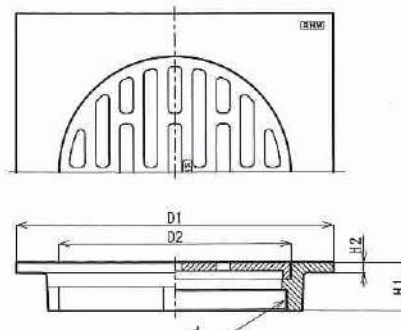
SCREWED TYPE CONNECTION**BSPT TYPE**

Dimensions.

(mm)

	d(BSP T)	D1	D2	H1	H2
63sq x 40	1-1/2"	63	48	20	2.5
79sq x 50	2"	79	59	20	2.5
109sq x 75	3"	109	86	21	2.5
150sq x 100	4"	150	110	23	2.5
200sq x 100	4"	200	110	36	4
200sq x 150	6"	200	162	36	4

BRASS MADE + CHROME PLATED

H-397

STAINLESS STEEL MADE + POLISHED

H-397-SS

※SS316 is available.

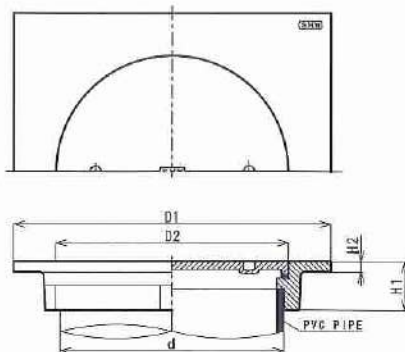
H-512SERIES**COVER TYPE CONNECTION****P TYPE**

Dimensions.

(mm)

	d	D1	D2	H1	H2
63sq x 40	43.5	63	48	20	2.5
79sq x 50	56.5	79	59	20	2.5
109sq x 75	82.5	109	86	21	2.5
150sq x 50	110.5	150	59	20	2.5
150sq x 75	82.5	150	86	21	4
150sq x 100	110.5	150	110	23	2.5
200sq x 100	110.5	200	110	36	4
200sq x 150	160.5	200	162	36	4

BRASS MADE + GOLDEN COLOR PLATED**H-512-P-GOLD****BRASS MADE + CHROME PLATED****H-512-P****STAINLESS STEEL MADE + POLISHED****H-512-P-SS**

※SS316 is available.

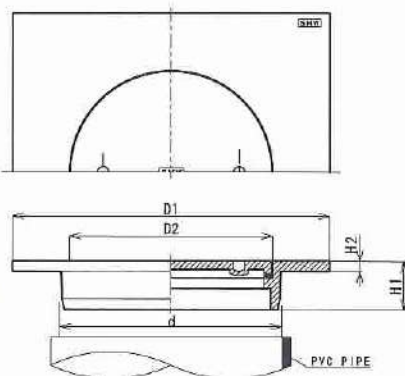
PUSH-FIT TYPE CONNECTION**PF TYPE**

Dimensions.

(mm)

	d	D1	D2	H1	H2
63sq x 40	40	63	37	20	2.5
79sq x 50	51	79	47	20	2.5
109sq x 75	77	109	73	21	2.5
150sq x 100	103	150	96	23	2.5
200sq x 100	103	200	96	23	2.5
200sq x 150	146	200	137	36	4

BRASS MADE + CHROME PLATED**H-512-PF****STAINLESS STEEL MADE + POLISHED****H-512-PF-SS**

※SS316 is available.

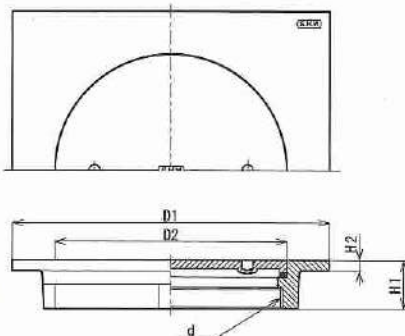
SCREWED TYPE CONNECTION**BSPT TYPE**

Dimensions.

(mm)

	d(BSPT)	D1	D2	H1	H2
63sq x 40	1-1/2"	63	48	20	2.5
79sq x 50	2"	79	59	20	2.5
109sq x 75	3"	109	86	21	2.5
150sq x 100	4"	150	110	23	2.5
200sq x 100	4"	200	110	36	4
200sq x 150	6"	200	162	36	4

BRASS MADE + CHROME PLATED**H-512****STAINLESS STEEL MADE + POLISHED****H-512-SS**

※SS316 is available.



SAKURA

FLOOR DRAIN SERIES

NEW ECONOMICAL FLOOR DRAIN

STAINLESS STEEL (SS304) TOP & STRONG ABS CORE

(SS316 is available.)

"SAKURA" is Japanese traditional beautiful flower which is loved by all. Our "SAKURA" series FLOOR DRAIN comes from this SAKURA.

They are beautiful, strong and light.



H-514-WT-PF-SS-ABS

Dimensions.	(mm)				
	d	D1	D2	H1	H2
150sq x 100	103	150	96	32	7
200sq x 100	103	200	96	32	7
200sq x 150	143	200	137	36	7



FLOOR DRAIN

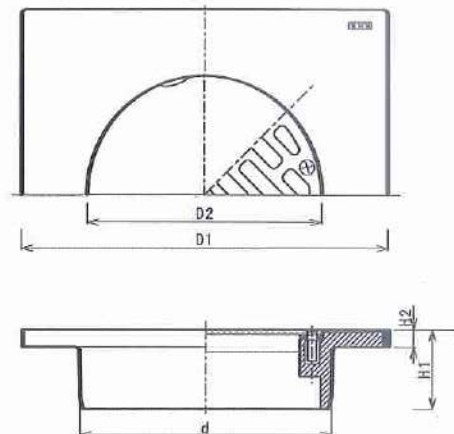

H-397-PF-SS-ABS

Dimensions.	(mm)				
	d	D1	D2	H1	H2
150sq x 100	103	150	96	32	7
200sq x 100	103	200	96	32	7
200sq x 150	143	200	137	36	7



GRATING

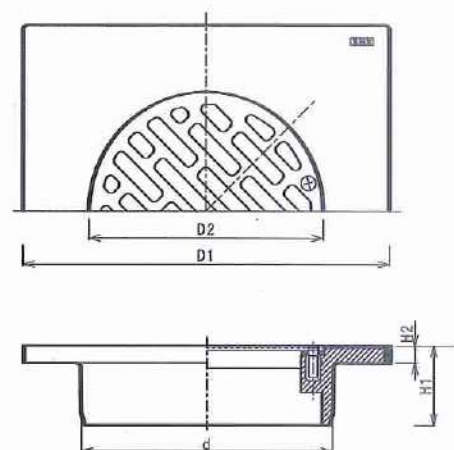

H-512-PF-SS-ABS

Dimensions.	(mm)				
	d	D1	D2	H1	H2
150sq x 100	103	150	96	32	7
200sq x 100	103	200	96	32	7
200sq x 150	143	200	137	36	7

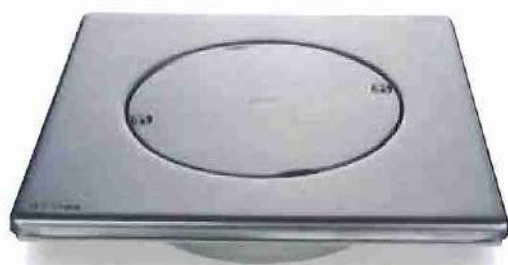

CLEANOUT

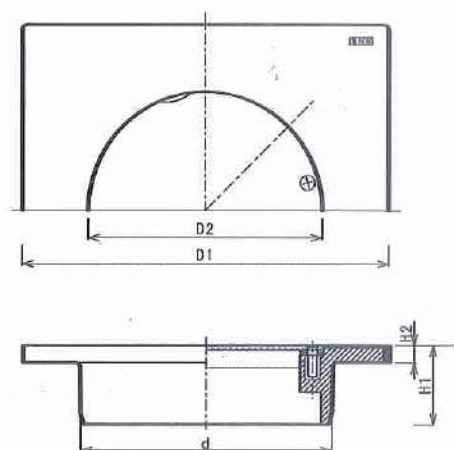

FEATURES of "SAKURA" series

Advantage Part1

"SAKURA" series are produced by HAMADA and the quality is completely same as HAMADA "Traditional Floor Drain" series.



Advantage Part2

"SAKURA" series are designed and produced very precisely. The loose cover of H-514-WT-PF-SS-ABS fits neatly into the base.



Advantage Part3

All the thread parts of SAKURA series are covered with plastic core body and never touch the wasted water. Therefore, the wasted water runs smoothly and all the screws will not get rusted. Any slurry will not tangle in the floor drain, either. It is hygienically designed.



Advantage Part4

SHW "SAKURA" series is composed with 2mm thick SS plate and ABS plastic, therefore, is strong enough to withstand the load.

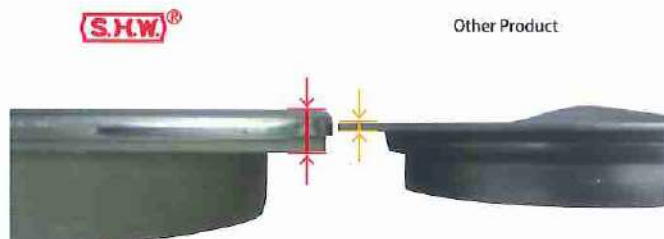

Advantage Part5

SHW "SAKURA" series does not have any cavities, therefore, is very hygienical.



Advantage Part6

SHW "SAKURA" series has the widest drainage area and provides big flow rate.





HAMADA MFG. CO.,LTD.

OSAKA,JAPAN

<http://www.s-h-w.net>

ROUND TYPE SERIES

H-340 CLEANOUT, SCREWED FEMALE (B.S.P.T.) OUTLET



Dimensions.

(mm)

	d(BSPT)	D1	D2	H1	H2
40	1-1/2"	55	47	21	6
50	2"	66	59	20	6
65	2-1/2"	81	73	18	6
75	3"	93	86	19	5
100	4"	118	110	20	6
125	5"	145	137	27	12
150	6"	173	162	32	13

BRASS MADE + CHROME PLATED

H-340

STAINLESS STEEL MADE + POLISHED

H-340-SS

※SS316 is available.

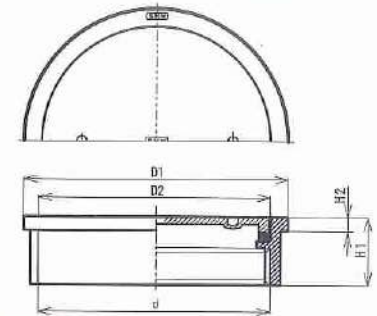

H-340-PF CLEANOUT, FOR PVC PIPE, PUSH FIT TYPE OUTLET



Dimensions.

(mm)

	d1	d2	D1	D2	H1	H2
40	40	44	50	37	25	2
50	51	56	62	47	25	2.5
65	67	71	78	63	25	2.5
75	77	83	91	73	25	3
100	100	107	116	96	25	3
125	125	131	142	121	31	4
150	146	154	167	137	32	4

BRASS MADE + CHROME PLATED

H-340-PF

STAINLESS STEEL MADE + POLISHED

H-340-PF-SS

※SS316 is available.

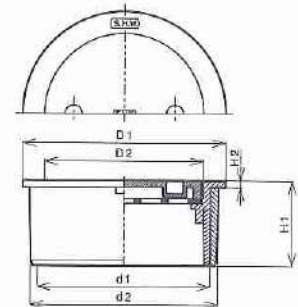

H-341-PF GRATING WITH WIDE FLANGE, FOR PVC PIPE, PUSH FIT TYPE OUTLET



Dimensions.

(mm)

	d1	d2	D1	D2	H1	H2
40	40	44	75	37	25	2
50	51	56	85	47	25	2.5
65	67	71	105	63	25	2.5
75	77	83	115	73	25	3
100	100	107	145	96	25	3
125	125	131	175	121	31	4
150	146	154	200	137	32	4

BRASS MADE + CHROME PLATED

H-341-PF

STAINLESS STEEL MADE + POLISHED

H-341-PF-SS

※SS316 is available.

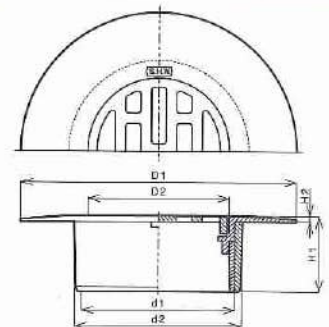

H-342-PF CLEANOUT WITH WIDE FLANGE, FOR PVC PIPE, PUSH FIT TYPE OUTLET



Dimensions.

(mm)

	d1	d2	D1	D2	H1	H2
40	40	44	75	37	25	2
50	51	56	85	47	25	2.5
65	67	71	105	63	25	2.5
75	77	83	115	73	25	3
100	100	107	145	96	25	3
125	125	131	175	121	31	4
150	146	154	200	137	32	4

BRASS MADE + CHROME PLATED

H-342-PF

STAINLESS STEEL MADE + POLISHED

H-342-PF-SS

※SS316 is available.

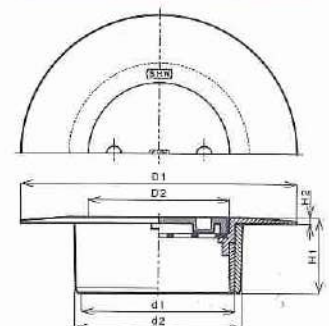

H-394-PF GRATING WITH P-TRAP, FOR PVC PIPE, PUSH FIT TYPE OUTLET



Dimensions.

(mm)

	d1	d2	D1	D2	H1	H2	H3
75 x 40	40	44	78	69	70	66	45
100 x 50	51	56	105	95	70	66	45

Parts and Materials.

No.	Name	Materials
1	Body	Brass
2	Grating	SUS
3	Socket	PVC

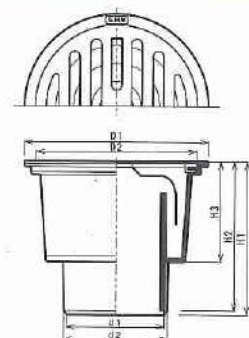

ROUND TYPE SERIES

H-395 GRATING, SCREWED FEMALE (B.S.P.T.) OUTLET



Dimensions. (mm)					
	d(BSPT)	D1	D2	H1	H2
40	1-1/2"	55	47	21	6
50	2"	66	59	20	6
65	2-1/2"	81	73	18	6
75	3"	93	86	19	5
100	4"	118	110	20	6
125	5"	145	137	27	12
150	6"	173	162	32	13

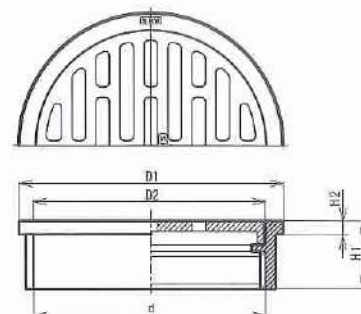

BRASS MADE + CHROME PLATED

H-395

STAINLESS STEEL MADE + POLISHED

H-395-SS

※SS316 is available.

H-395-PF GRATING, FOR PVC PIPE, PUSH FIT TYPE OUTLET



Dimensions. (mm)					
	d1	d2	D1	D2	H1
40	40	44	50	37	25
50	51	56	62	47	25
65	67	71	78	63	25
75	77	83	91	73	25
100	100	107	116	96	25
125	125	131	142	121	31
150	146	154	167	137	32

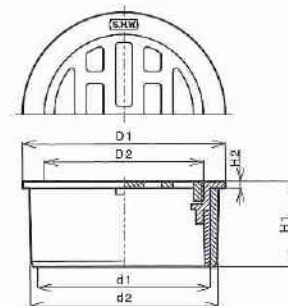

BRASS MADE + CHROME PLATED

H-395

STAINLESS STEEL MADE + POLISHED

H-395-SS

※SS316 is available.

H-396 INSECT PROOF GRATING, SCREWED FEMALE (B.S.P.T.) OUTLET



Dimensions. (mm)					
	d(BSPT)	D1	D2	H1	H2
40	1-1/2"	55	47	21	6
50	2"	66	59	20	6
65	2-1/2"	81	73	18	6
75	3"	93	86	19	5
100	4"	118	110	20	6
125	5"	145	137	27	12
150	6"	173	162	32	13

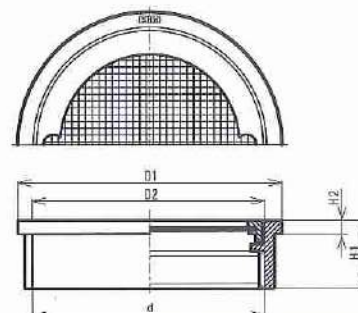

BRASS MADE + CHROME PLATED with SS MESH

H-396

H-396-PF INSECT PROOF GRATING, FOR PVC PIPE, PUSH FIT TYPE



Dimensions. (mm)					
	d1	d2	D1	D2	H1
40	40	44	50	37	25
50	51	56	62	47	25
65	67	71	78	63	25
75	77	83	91	73	25
100	100	107	116	96	25
125	125	131	142	121	31
150	146	154	167	137	32

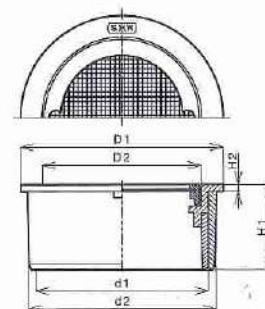

BRASS MADE + CHROME PLATED with SS MESH

H-396-PF

STAINLESS STEEL FLEXIBLE TUBE CONNECTOR

H-1525

(FULL CORRUGATED TYPE)



H-1525-H

(CORRUGATED TYPE. BOTH ENDS IS PLAIN END)

Size		LENGTH (mm)	
		LENGTH	
1/2"		200, 250, 300, 350, 400, 450, 500, 600, 700, 800, 900, 1000,	
3/4"		-ditto-	

TP-Series

DRAIN UNIT WITH P-TRAP

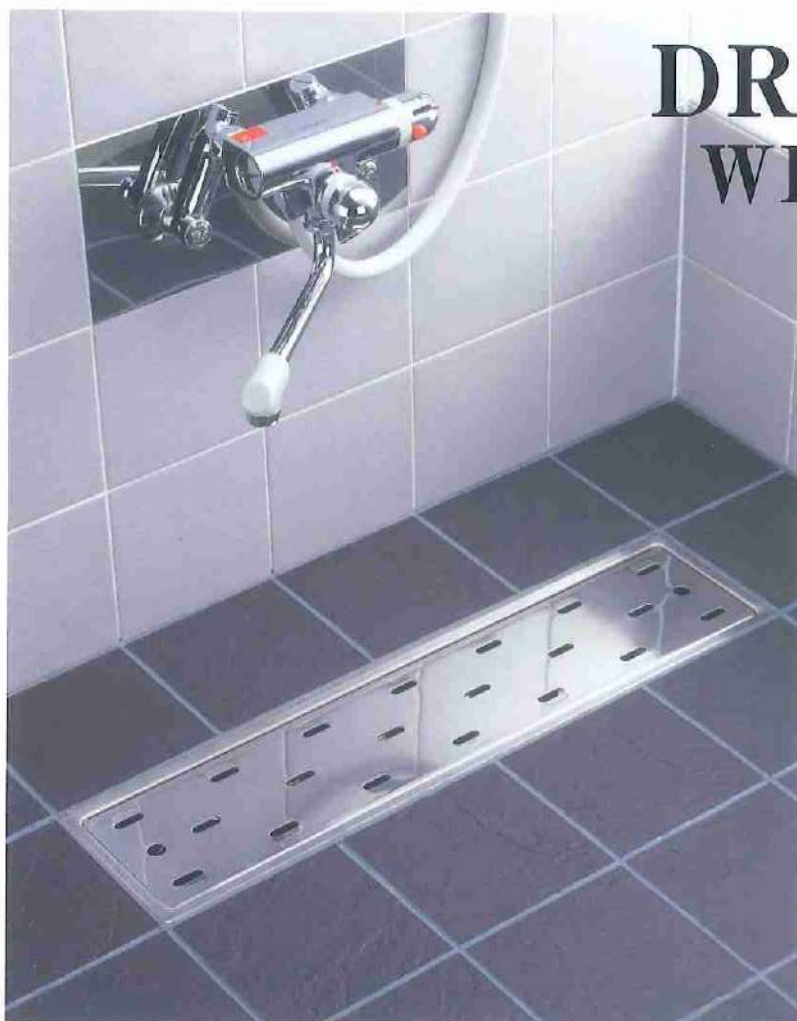

This is the new style valuable Floor Drain which meets with your cool tile arrangement. H-TP Series promises the comfortable drain design and environment. P-trap prevents the bad smell and insects from coming up. H-TP Series suits for 150mm square tile and 200mm square tile.

- It can be installed at horizontal and vertical piping.

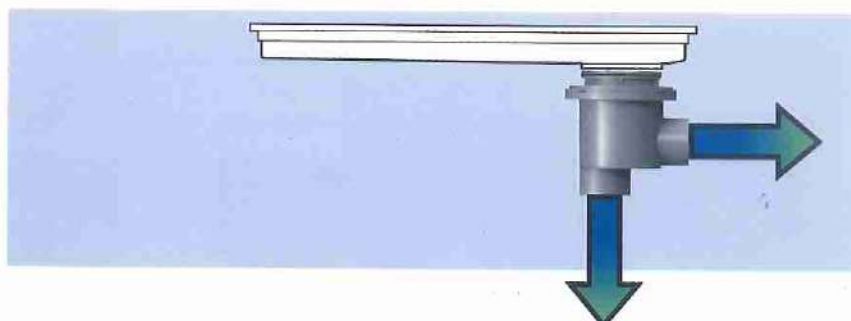

- In case vertical line.

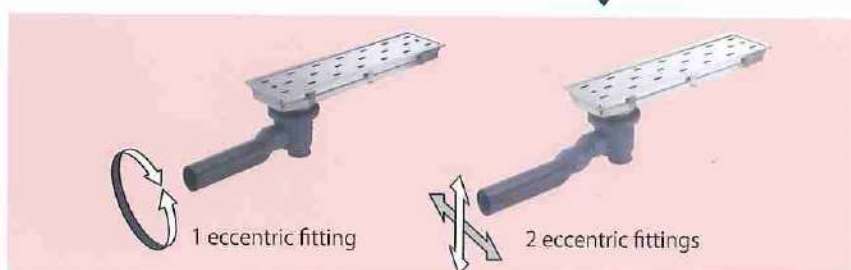

(One eccentric fitting is included the Packaging a eccentric fitting.)

TP-Series

Variation

● Edge Drain Type



150mm SQ tiles



with P-Trap



H-TPE-150S



H-TPE-150T



H-TPE-150Q



H-TPE-150F



200mm SQ tiles



250mm SQ tiles



with P-Trap



H-TPE-200S



H-TPE-200T



H-TPE-200Q



H-TPE-250S

● Center Drain Type

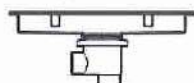

150mm SQ tiles



with P-Trap



H-TPC-150T



H-TPC-150Q

● You can adjust the Floor Drain location to meet with the tiles.

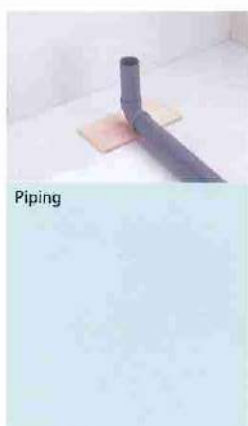

There is gap between tile and Floor Drain.



Perfect finish



Special Feature

- Even after installing the drain pan, it is possible to adjust the piping position without any problem. Capacity is within 36mm.



- You can choose horizontal line or vertical line without any problem.



H-TPE-150



Triple, Quadruple, Five

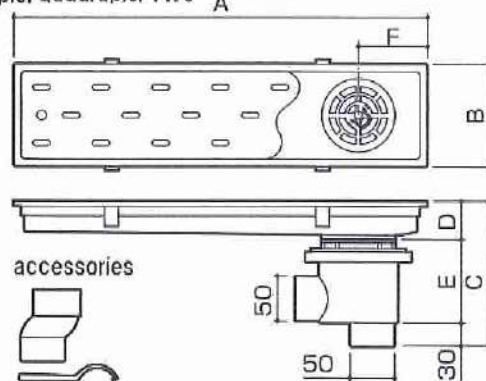

accessories

Single

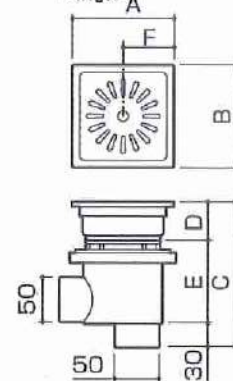

[150mm SQ type]

unit : mm

	A	B	C	D	E	F
H-TPE-150S	148	148	194	57.5	106.5	74
H-TPE-150T	448	148	193.5	57	106.5	100
H-TPE-150Q	598	148	194	57.5	106.5	100
H-TPE-150F	748	148	193.5	57	106.5	100

[200mm SQ type]

unit : mm

	A	B	C	D	E	F
H-TPE-200S	198	198	193.5	57	106.5	99
H-TPE-200T	598	198	176.5	40	106.5	150
H-TPE-200Q	798	198	177.5	41	106.5	150

[250mm SQ type]

unit : mm

	A	B	C	D	E	F
H-TPE-250S	248	248	193.5	57	106.5	124

H-TPC-150

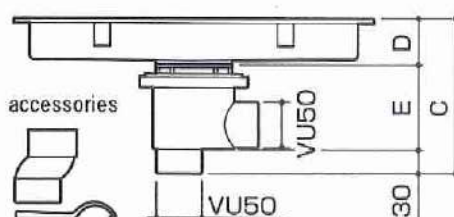
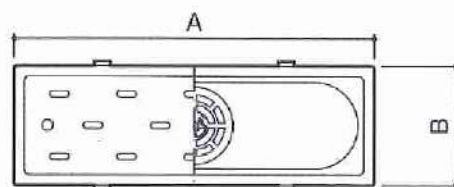

accessories

[150mm SQ type (Center Outlet Type)]

unit : mm

	A	B	C	D	E
H-TPC-150T	448	148	192.5	57.5	105
H-TPC-150Q	598	148	194	59	105

P-type Floor Drain

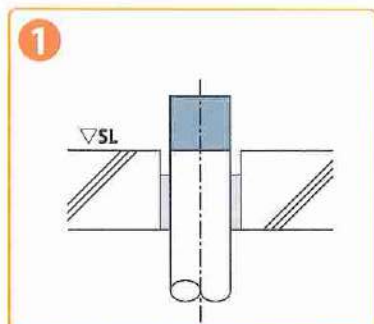

Be adjusted dependent upon height of finished floor.

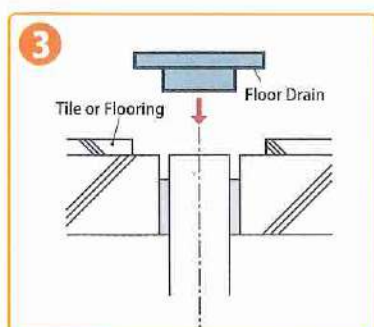
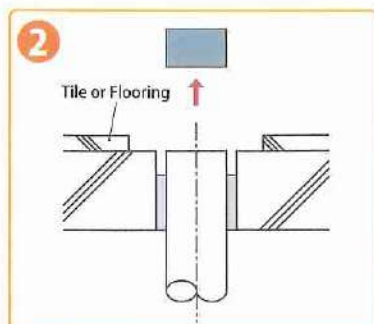

Install the Floor Drain.

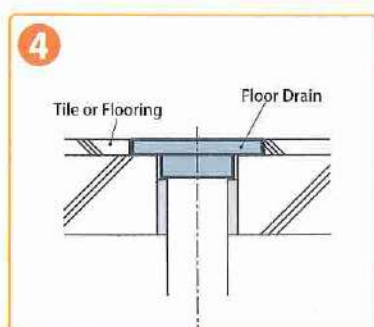

Completed.

PF-type Floor Drain

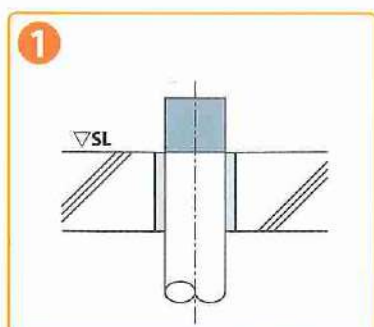

Be adjusted dependent upon height of finished floor.

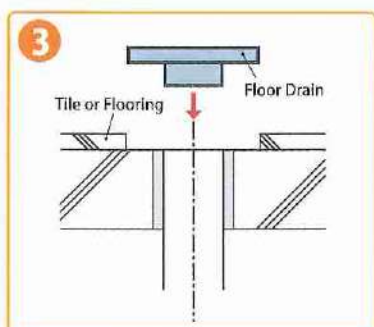
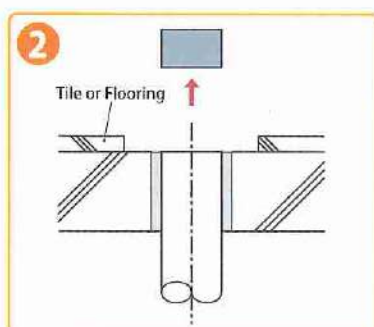

Install the Floor Drain.

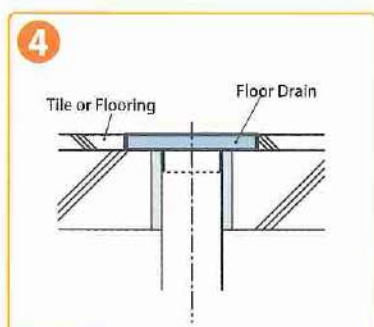

Completed.

PRECAUTION IN HANDLING OF "SHW" FLOOR DRAINS

MAINTENANCE

- Do not put adhesive tape such as masking tape on our products. The chemicals in the tape may damage the plated surface.

WASHING & CLEANING

- Use of chemicals & detergents for cleaning is to be avoided, especially acid based detergents.

KEEPING

- To maintain its beauty, clean regularly with a dry and soft cloth.

PRECAUTION IN KEEPING

- Our Chrome Plated Floor Drain can keep brightness for long years unless otherwise Big mis-usage such as outside use and/or scrub hard etc.
- Direct sun-ray should be avoided when our goods for stored long period of time.

Air-cleaning wall-coverings[®] **TF-V**

Cleaning Air by the Wallpaper !

Solution for bad odor in your room. New deodorant wall-coverings

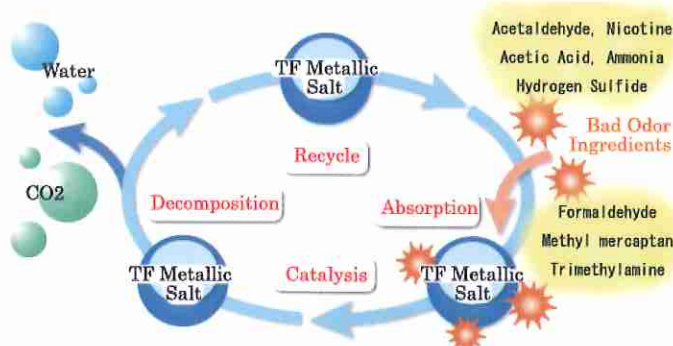

Air-cleaning wall-coverings TF-V decomposes bad odor components into water and carbon dioxide by its semipermanent cyclized odor eliminating function. This effect lasts repeatedly!

Air-cleaning wall-coverings TF-V' can decompose following odor materials

Acetaldehyde, Hydrogen sulfite, Formaldehyde, Acetic acid, Ammonia, Trimethylamine, Methyl mercaptan, Nicotine.

● Main components of each odor

- 1) Cigarette odor --- Nicotine, Aldehyde, Acetic acid
- 2) Garbage odor --- Hydrogen Sulfite, Trimethylamine, Methyl mercaptan. etc.
- 3) Human waste odor - Ammonia, Hydrogen Sulfite, Methyl mercaptan. etc.
- 4) Animal odor --- Ammonia, Hydrogen Sulfite, Trimethylamine, Methyl mercaptan

■ 'Air-cleaning wall-coverings TF-V' can NOT decompose following odor.

- 1) Aromatic compounds such as incense, perfume, toluene, xylene. etc.
- 2) Mold odor



GAINA

High Quality & Multi Function Heat Insulating Paint

GAINA is the high quality and multi function heat insulating paint using space development technology. GAINA makes clear distinction from normal coatings by taking advantage of the effect of special ceramics. The main inclusion ceramic of GAINA specializes in thermal insulation and GAINA contains other functional ceramics which are effective in other points such as noise insulation, dew condensation prevention, heat barrier, well ion balance and others.



Reflects about 95% of the influences from the solar ray!
Decreases outside noise by 4 to 10 decibels!



[Heat barrier effect produces 29 deg. C difference]

● Temperature comparison between concrete surface and GAINA coated surface



Surface temperature of the concrete roof is 63.2 deg. C
(Air temp. is 33 deg. C.)

29 deg. C difference



● **After GAINA coated**
Surface temperature is only 34 deg. C
(Air temp. is 34 deg. C.)



(S.H.W.)®

HAMADA MFG. CO.,LTD.

OSAKA,JAPAN

<http://www.s-h-w.net>

Distributor

